

Installation Procedure

Finisher, Sorter, DeliveryTray Paper Folding Unit-D1

Canon

Application

This manual has been issued by Canon Inc. for qualified persons to learn technical theory, installation, maintenance, and repair of products. This manual covers all localities where the products are sold. For this reason, there may be information in this manual that does not apply to your locality.

Corrections

This manual may contain technical inaccuracies or typographical errors due to improvements or changes in products. When changes occur in applicable products or in the contents of this manual, Canon will release technical information as the need arises. In the event of major changes in the contents of this manual over a long or short period, Canon will issue a new edition of this manual.

The following paragraph does not apply to any countries where such provisions are inconsistent with local law.

Trademarks

The product names and company names used in this manual are the registered trademarks of the individual companies.

Copyright

This manual is copyrighted with all rights reserved. Under the copyright laws, this manual may not be copied, reproduced or translated into another language, in whole or in part, without the written consent of Canon Inc.

COPYRIGHT © 2001 CANON INC.









Printed in Japan

Caution



Use of this manual should be strictly supervised to avoid disclosure of confidential information.

Symbols Used

This documentation uses the following symbols to indicate special information:

| Symbol | Description |
|---|---|
|  | Indicates an item of a non-specific nature, possibly classified as Note, Caution, or Warning. |
|  | Indicates an item requiring care to avoid electric shocks. |
|  | Indicates an item requiring care to avoid combustion (fire). |
|  | Indicates an item prohibiting disassembly to avoid electric shocks or problems. |
|  | Indicates an item requiring disconnection of the power plug from the electric outlet. |
|  Memo | Indicates an item intended to provide notes assisting the understanding of the topic in question. |
|  REF. | Indicates an item of reference assisting the understanding of the topic in question. |
|  | Provides a description of a service mode. |
|  | Provides a description of the nature of an error indication. |

The following rules apply throughout this Service Manual:

1. Each chapter contains sections explaining the purpose of specific functions and the relationship between electrical and mechanical systems with reference to the timing of operation. In the diagrams,  represents the path of mechanical drive; where a signal name accompanies the symbol, the arrow  indicates the direction of the electric signal.

The expression "turn on the power" means flipping on the power switch, closing the front door, and closing the delivery unit door, which results in supplying the machine with power.

2. In the digital circuits, '1' is used to indicate that the voltage level of a given signal is "High", while '0' is used to indicate "Low". (The voltage value, however, differs from circuit to circuit.) In addition, the asterisk (*) as in "DRMD*" indicates that the DRMD signal goes on when '0'.

In practically all cases, the internal mechanisms of a microprocessor cannot be checked in the field. Therefore, the operations of the microprocessors used in the machines are not discussed: they are explained in terms of from sensors to the input of the DC controller PCB and from the output of the DC controller PCB to the loads.

The descriptions in this Service Manual are subject to change without notice for product improvement or other purposes, and major changes will be communicated in the form of Service Information bulletins.

All service persons are expected to have a good understanding of the contents of this Service Manual and all relevant Service Information bulletins and be able to identify and isolate faults in the machine."

Contents

Chapter 1 Installation Procedure

| | |
|---|----|
| 1.1 Making Pre-Checks | 2 |
| 1.1.1 Checking the Contents | 3 |
| 1.2 Preparation Before Installation | 5 |
| 1.2.1 Preparation Before Installation | 5 |
| 1.3 Installation Procedure | 8 |
| 1.3.1 Preparing the Finisher | 8 |
| 1.3.2 Mounting the Folder Unit | 11 |
| 1.3.3 Connecting to the Host Machine | 15 |
| 1.3.4 Connecting to the High-Capacity Stacker | 19 |
| 1.3.5 Connecting to the Professional Puncher | 23 |
| 1.3.6 Mounting the Covers | 28 |
| 1.3.7 Mounting the Sub Tray Drive Unit | 29 |
| 1.3.8 After the Work | 31 |
| 1.3.9 Checking the Height | 32 |
| 1.4 Making Adjustments | 33 |
| 1.4.1 Horizontal Registration/Skew Adjustment | 33 |
| 1.4.2 Folding Stopper Adjustment | 37 |

Chapter 1 Installation Procedure

1.1 Making Pre-Checks

1.1.1 Checking the Contents

0011-4360

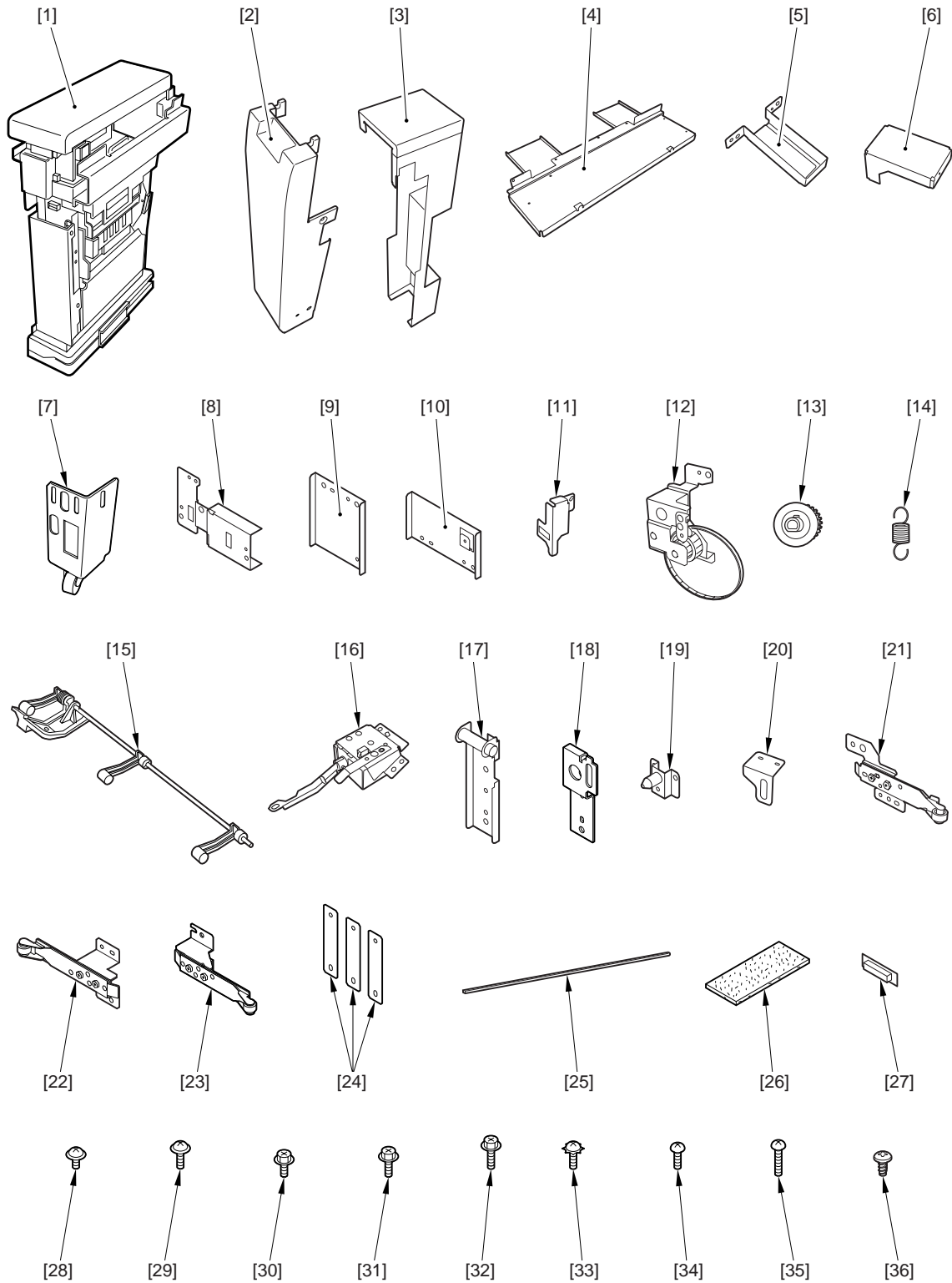

F-1-1

| | | | | | |
|------|-----------------------------------|-------|------|--|--------|
| [1] | Folder unit | 1 pc. | [19] | Positioning pin | 1 pc. |
| [2] | Front cover | 1 pc. | [20] | Reinforcing plate | 1 pc. |
| [3] | Rear cover | 1 pc. | [21] | Left guide retainer | 1 pc. |
| [4] | Folder mounting plate | 1 pc. | [22] | Right guide retainer (for front) | 1 pc. |
| [5] | Rear cover mounting plate (upper) | 1 pc. | [23] | Right guide retainer (for rear) | 1 pc. |
| [6] | Rear cover mounting plate (lower) | 1 pc. | [24] | Adjusting spacer | 3 pc. |
| [7] | Caster unit | 1 pc. | [25] | Upper cover spacer | 1 pc. |
| [8] | Fixing plate (front) | 1 pc. | [26] | Sponge | 2 pc. |
| [9] | Fixing plate (upper) | 1 pc. | [27] | Stopper rubber | 1 pc. |
| [10] | Fixing plate (lower) | 1 pc. | [28] | Screw (TP; M4X6; black) | 32 pc. |
| [11] | Switch cover | 1 pc. | [29] | Screw (TP; M4X10; black) | 2 pc. |
| [12] | Drive unit | 1 pc. | [30] | Screw (RS tightening; M4X8; white) | 8 pc. |
| [13] | Pulley gear | 1 pc. | [31] | Screw (RS tightening; M4X10; white) | 7 pc. |
| [14] | Drive spring | 1 pc. | [32] | Screw (RS tightening; M4X12; white) | 2 pc. |
| [15] | Lever unit | 1 pc. | [33] | Screw (binding; w/washer; M4X6; white) | 2 pc. |
| [16] | Solenoid unit | 1 pc. | [34] | Screw (binding; M4x6; white) | 3 pc. |
| [17] | Latch plate | 2 pc. | [35] | Screw (binding; M4X16; black) | 2 pc. |
| [18] | Folder bin plate | 1 pc. | [36] | Screw (P tightening; M4X8; black) | 3 pc. |

1.2 Preparation Before Installation

1.2.1 Preparation Before Installation

0011-4406

- 1) Remove the front reinforcing plate [1] and the rear reinforcing plate [2].
- 4 screws [3]

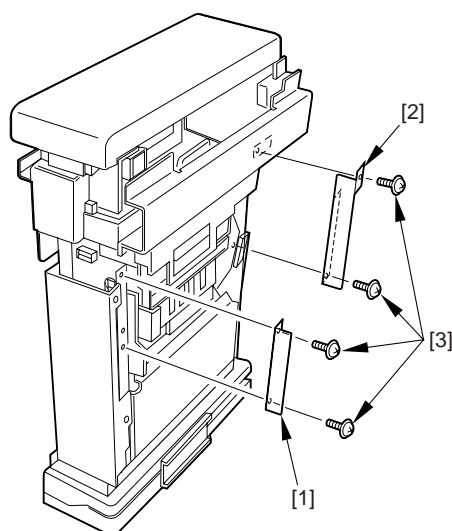

F-1-2

- 2) Remove the inside cover (front) [1].
- 4 screws [2]

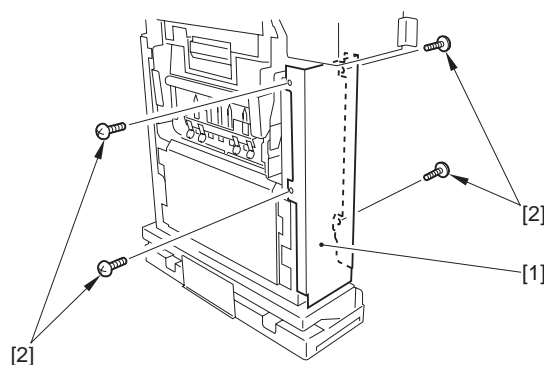

F-1-3

- 3) Remove the inside cover (rear) [1].
- 4 screws [2]

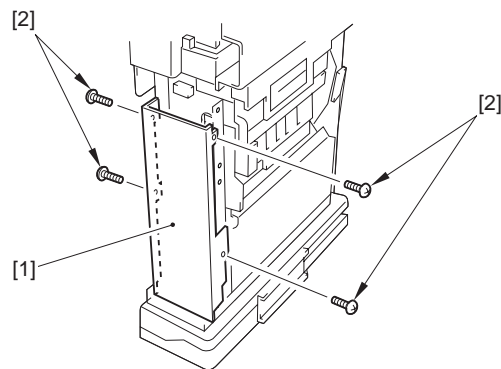

F-1-4

4) Pull on the B4 lever [1], and open the right guide [2]. [A]

Pull on the B4 lever [1] more, and pull out the right [2] until it stops at the very front. [B]

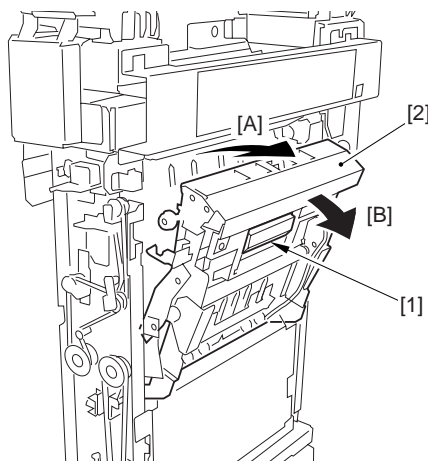

F-1-5

5) Remove the releasing spacer [1] at the front, and detach the shipping tag [2].

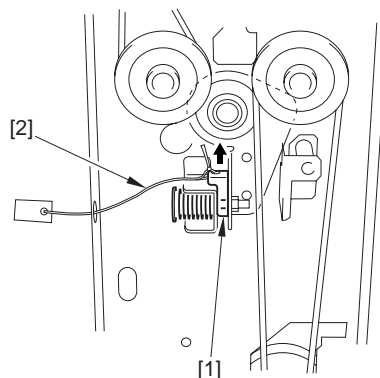

F-1-6

6) Fit the releasing spacer [1]. (front)

- 1 screw (binding; M4X16; black) [2]

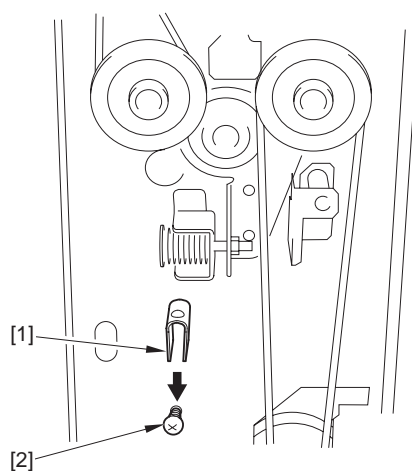

F-1-7

7) Remove the releasing spacer [1] at the rear, and detach the shipping tag [2].

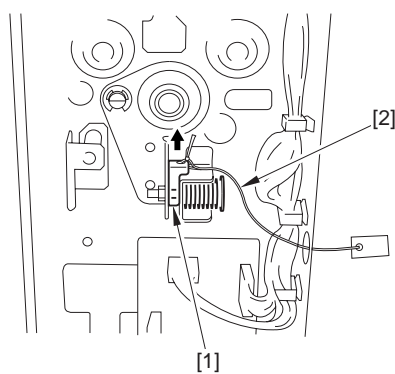

F-1-8

8) Fit the releasing spacer [1]. (rear)
- 1 screw (binding; M4X16; black) [1]

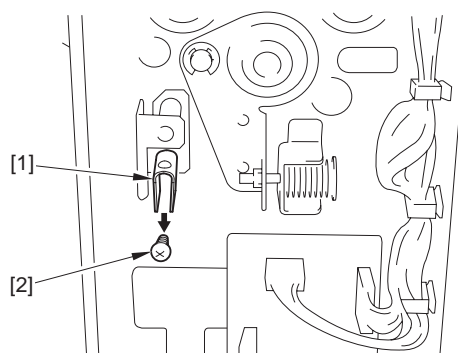

F-1-9

9) Put back the right unit, and mount the inside cover (front, rear).

1.3 Installation Procedure

1.3.1 Preparing the Finisher

0011-4416

- 1) Open the front cover of the finisher.
- 2) Remove the knob [1] from the inside cover (upper).

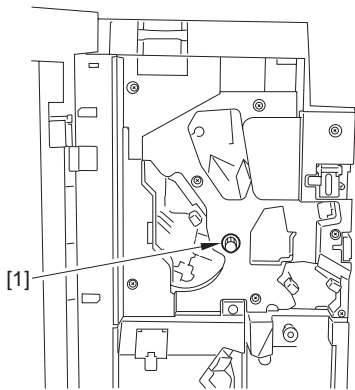

F-1-10

- 3) Lift the upper cover [1], and remove the inside cover (upper) [2].
- 8 screws [3]

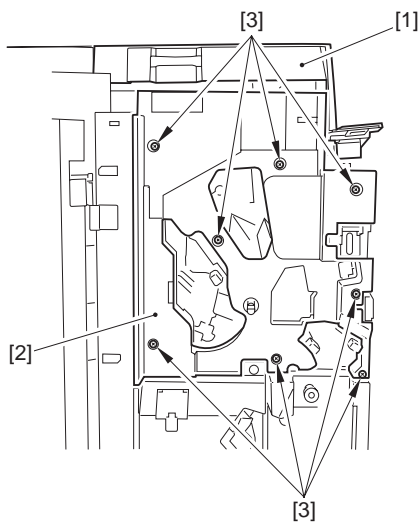

F-1-11

- 4) Remove the middle rear cover [1].
- 4 screws [2]

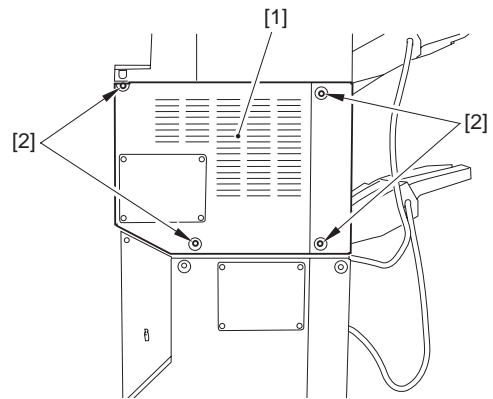

F-1-12

- 5) Remove the lower rear cover [1].
- 8 screws [2]

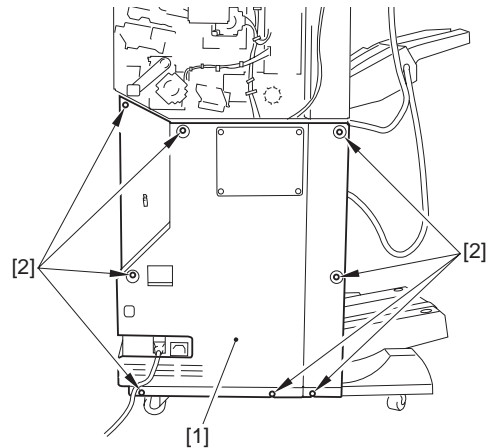

F-1-13

- 6) Remove the positioning plate [1]. (The removed positioning plate will no longer be used.)
- 2 screws [2]

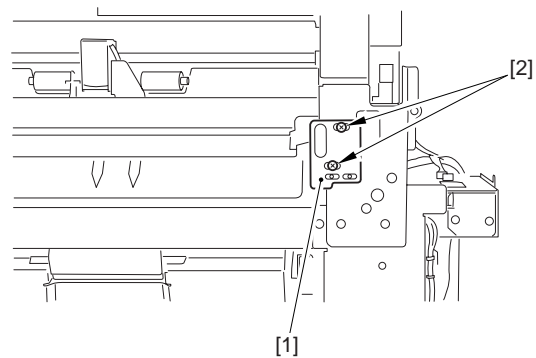

F-1-14

- 7) Remove the screw [2] of the latch base (rear) [1], and shift it toward the front.

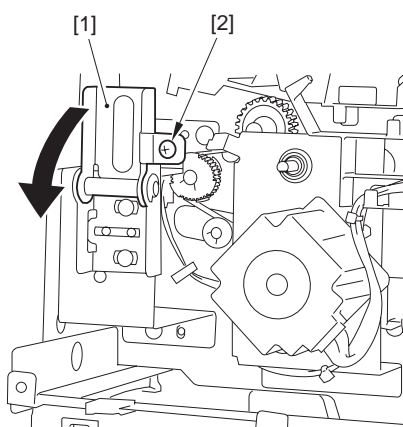

F-1-15

- 8) Remove the latch base unit [1]. (The removed latch base unit will no longer be used.)
- 2 screws [2]

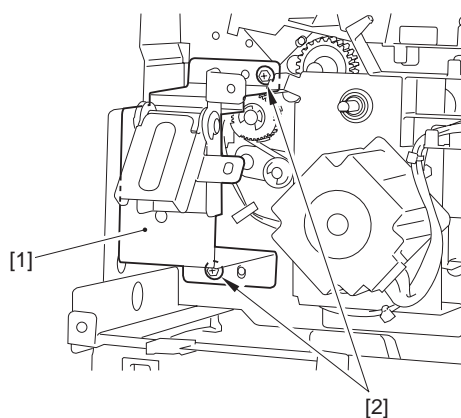

F-1-16

- 9) Fit the pulley gear [1].

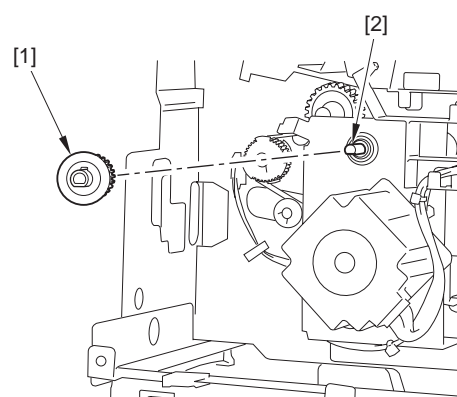

F-1-17

- 10) While attaching the timing belt [2] on the pulley gear [1], mount the drive unit [3] in place.
- 2 screws [4] (Use the screws removed in step 8.)



Attach the timing belt [2] so that it is located under the pulley [5] inside of the tensioner.

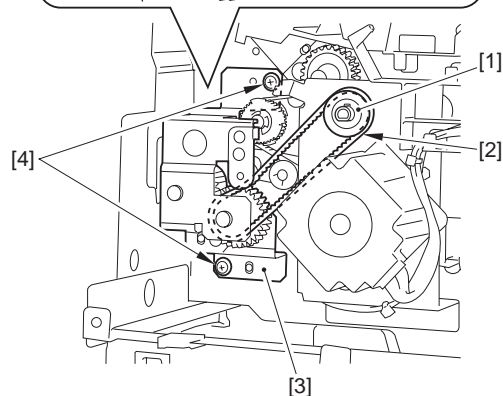
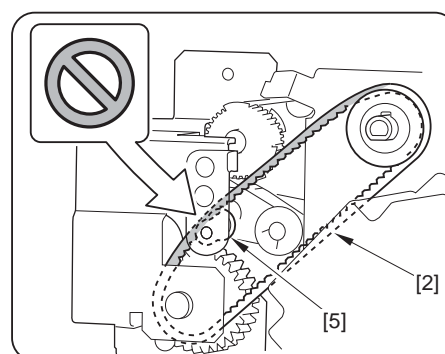

F-1-18

- 11) Loosen the screw [2] of the tensioner [1], and hook the drive spring [3] on the drive unit.

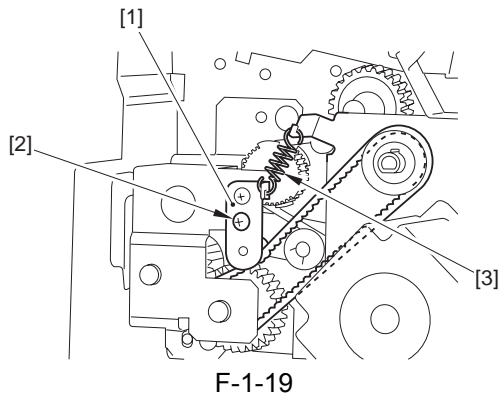

- 12) Loosen the screw [2] on the tensioner [1].



The force of the drive spring [3] moves the tensioner [1] at an angle. Tighten the screw [2] while maintaining the angle.

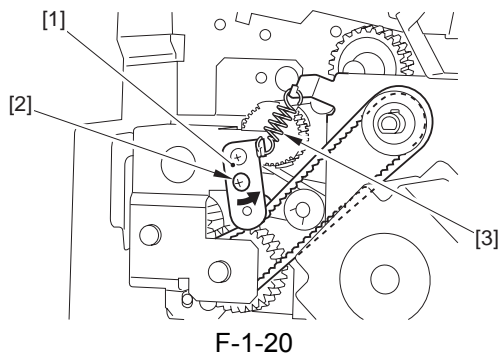

- 13) Mount the fixing plate (upper) [1] and the fixing plate (lower) [2].
- 4 screws (TP; M4X6; black) [3]

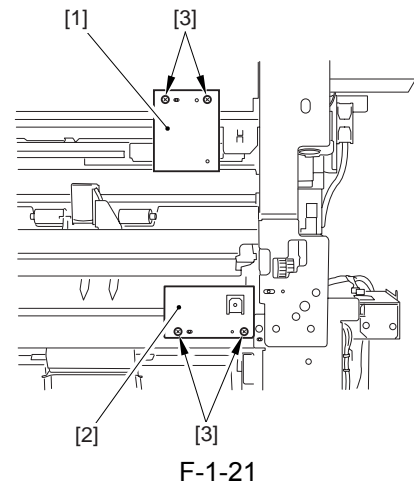

- 14) Mount the fixing plate (front) [1].
- 3 screws (TP; M4X6; black) [3]

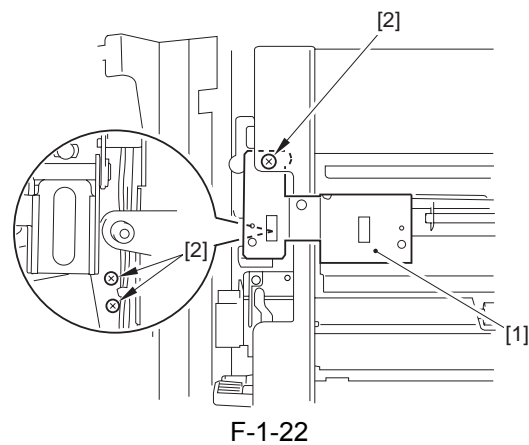

- 15) Mount the switch cover [1].
- 1 screw (TP; M4X6; black) [2]

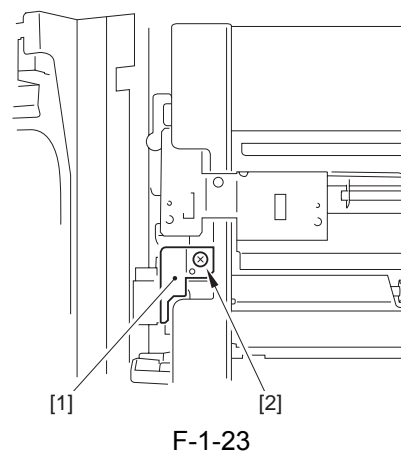

- 16) Mount the left guide retainer [1].
- 2 screws (TP; M4X6; black) [2]

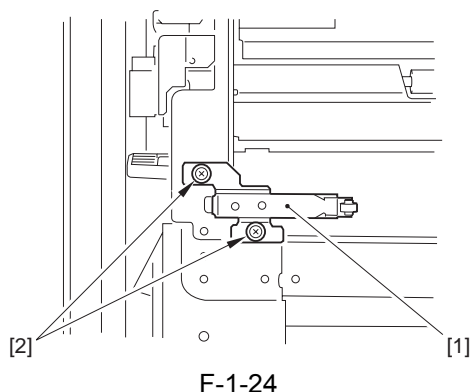

- 17) In the case of the Saddle Finisher-V2, slide out the saddle assembly [1].

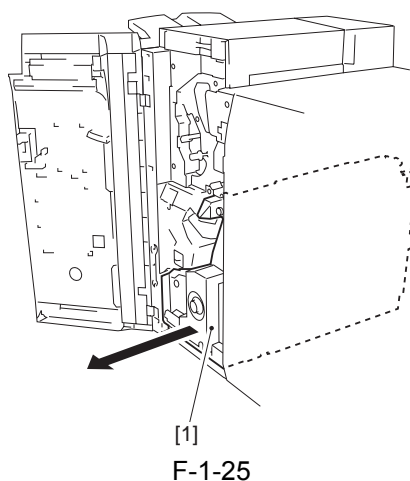

- 18) Mount the folder mounting plate [1].
- 5 screws (TP; M4X6; black) [2]

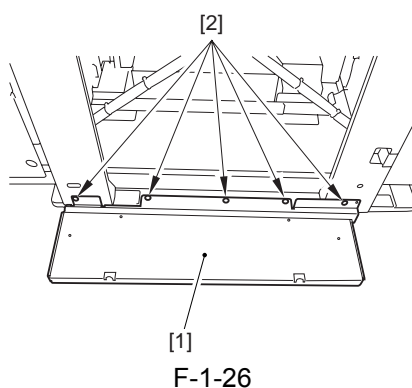

- 19) Slide the saddle assembly back in.

1.3.2 Mounting the Folder

Unit

0011-4421

- 1) Holding the reinforcing stay [1] and the frame assembly [2], lift the folder unit [3], and place it in position by matching it against the claw [5] of the folder mounting plate [4].

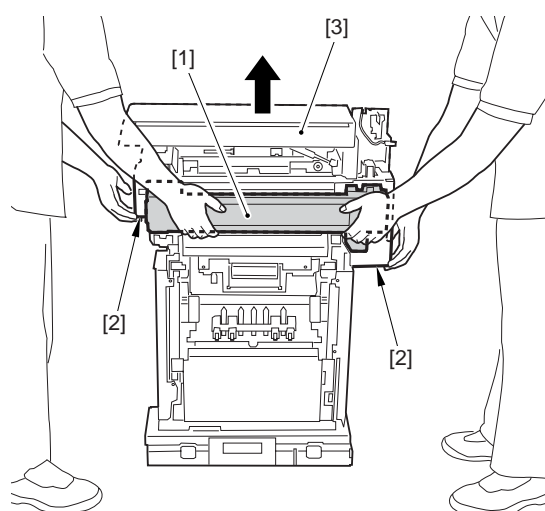

F-1-27

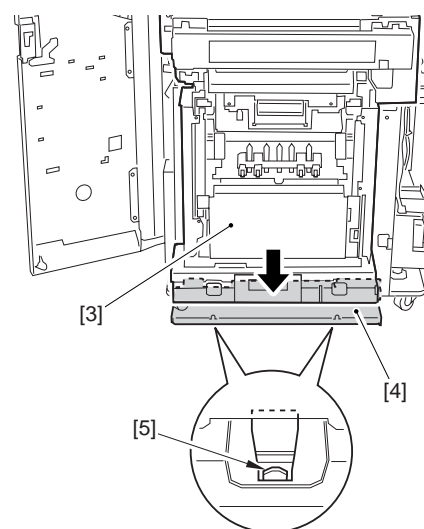

F-1-28

- 2) Fit the positioning pin [1] in the hole [2] of the fixing plate.

<Front>

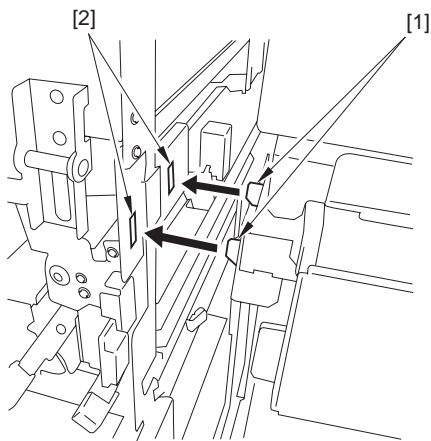

F-1-29

<Rear>

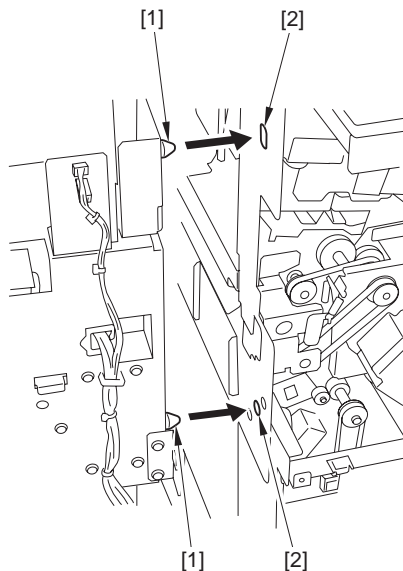

F-1-30

- 3) Secure the folder unit [1] in place.
- 4 screws (TP; M4X6; black) [2]

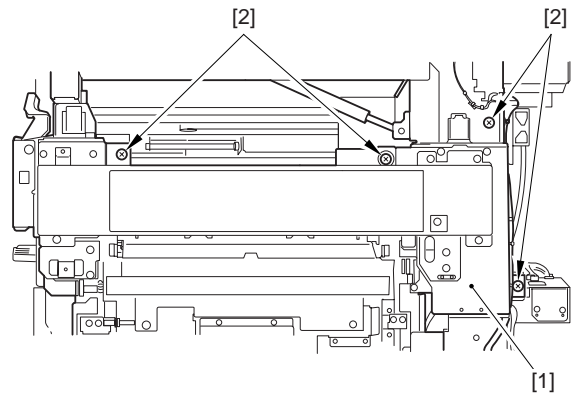

F-1-31

- 4) Remove the reinforcing stay [1].
- 7 screws [2]

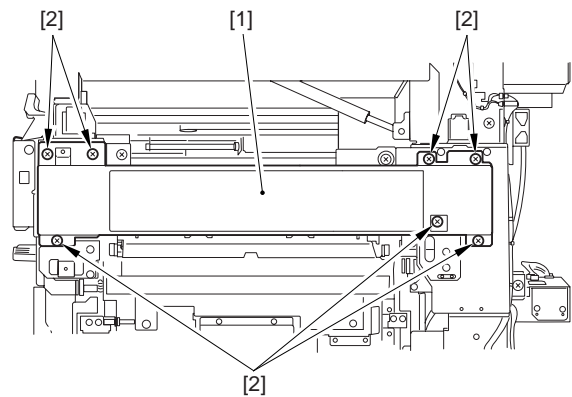

F-1-32

- 5) Mount the caster unit [1].
- 3 screws (TP; M4X6; black) [2]

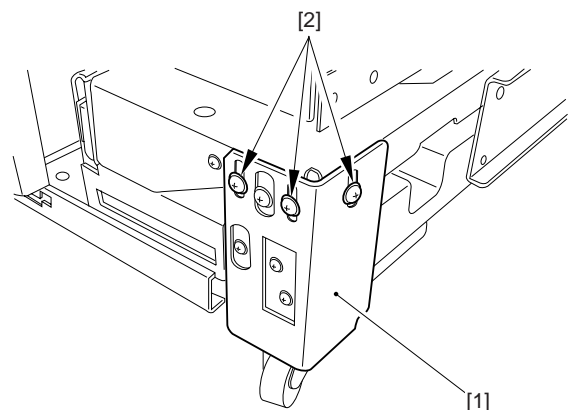

F-1-33

- 6) Remove the joint plate (lower) [1].

- 4 screws [2]

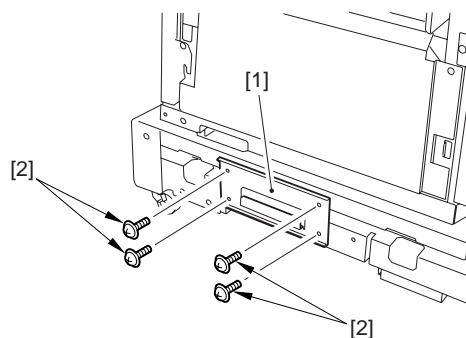

F-1-34

- 7) Shift down the joint plate [1] to secure it in place.
- 2 screws [2] (Use the screw removed in step 6.)

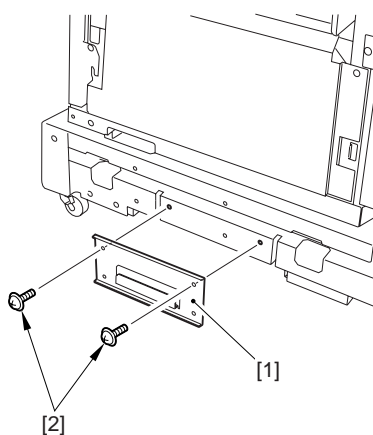

F-1-35

- 8) Open the upper cover [1], and slide out the folder assembly [2].

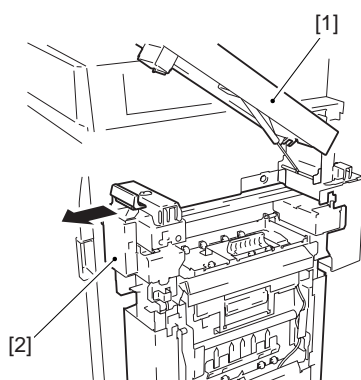

F-1-36

- 9) Fix the base plate [1] of the folder unit in place.

- 4 screws (TP; M4X6; black) [2]

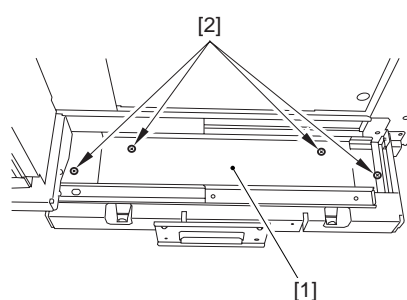

F-1-37

- 10) Fix the frame assembly [1] of the folder unit in place.

- 2 screws (TP; M4X6; black) [2]

<Front>

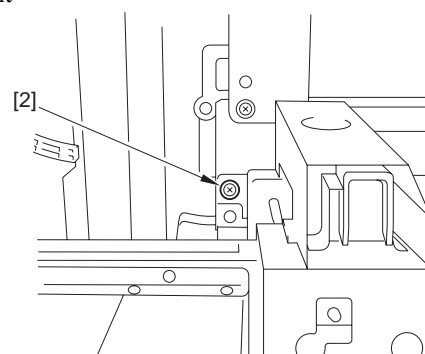

F-1-38

<Rear>

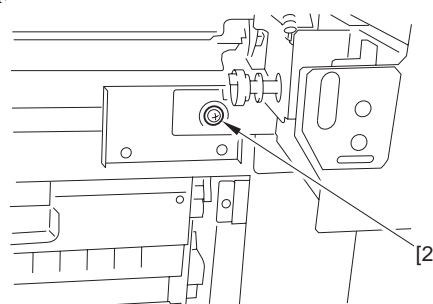

F-1-39

- 11) Put back the folder assembly, and close the upper cover.

- 12) Fix the rear cover fixing plate (upper) [1] in place.
- 2 screws (TP; M4X6; black) [2]

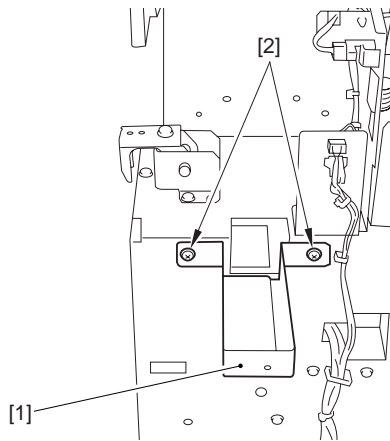

F-1-40

13) Fix the rear cover mounting plate (lower) [1] in place.

- 2 screws (TP; M4X6; black) [2]

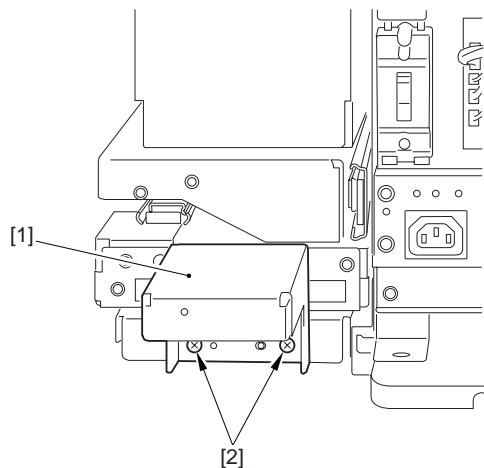

F-1-41

14) Fit the cable [1] from the folder unit to the finisher controller [2].

- 4 cable clamps [3]

- 2 connectors [4]

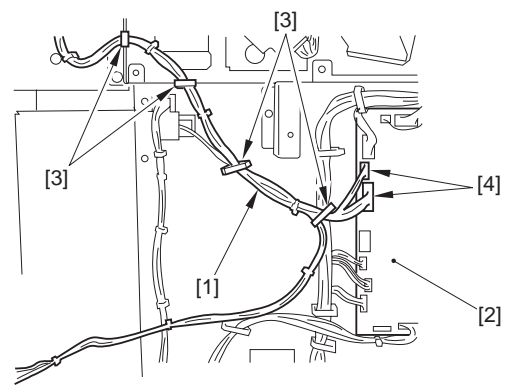

F-1-42

15) Remove the shorting connector [2] of the fuse box PCB [1].

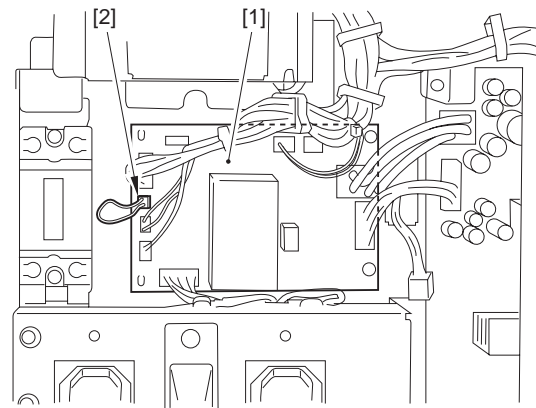

F-1-43

16) Fix the cable [1] from the folder unit in place.

- 6 cable clamps [2]

17) Fit the shorting connector [3] with the cable [1], and connect the 2 connectors [5] to the fuse box PCB [4].

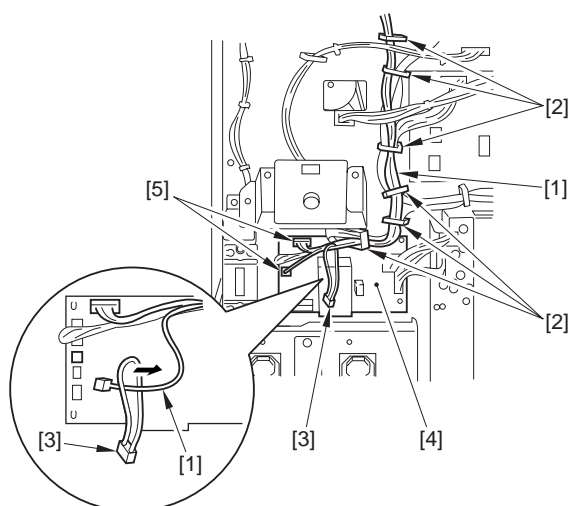

F-1-44

18) Fit the upper cover spacer [1] to the upper cover.

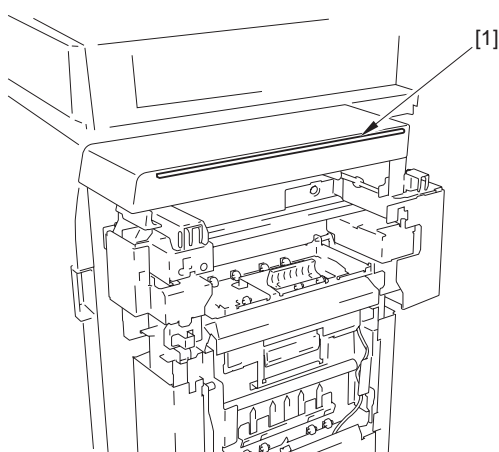

F-1-45

1.3.3 Connecting to the Host Machine

0011-4608

- 1) Fit the latch plate [1] and the folder bin holder (front) [2] to the host machine's left cover.
- 4 screws (RS tightening; M4X10; white) [3]

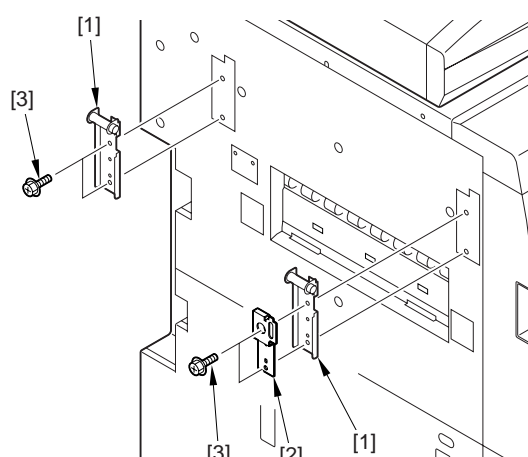

F-1-46

- 2) Fit the positioning pin [1].
- 2 screws (RS tightening; M4X10; white) [2]

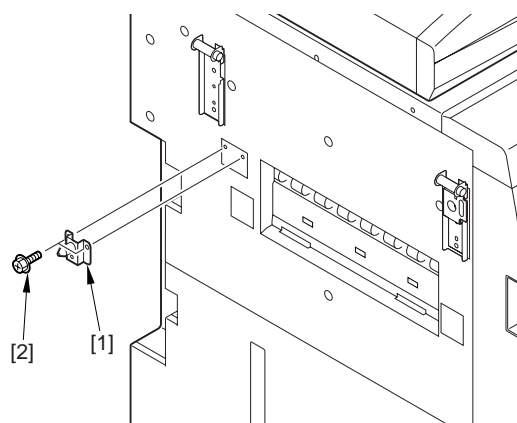

F-1-47

- 3) Mount the included delivery guide [1] to the host machine.

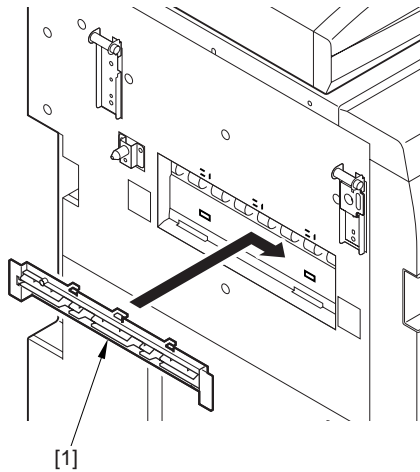

F-1-48

- 4) Mount the front right guide retainer [1] and the rear right guide retainer [2].
- 4 screws (RS tightening; M4X8; white) [3]

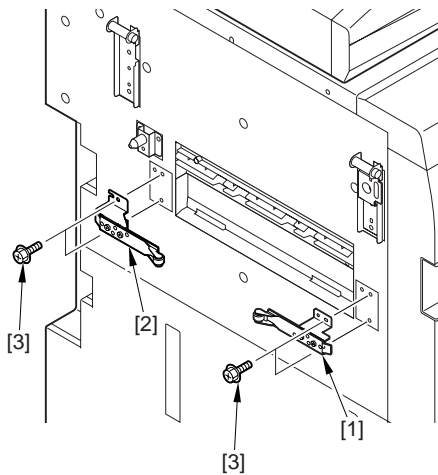

F-1-49

- 5) Open the upper cover of the folder unit, and remove the magnet catch plate [1].
- 2 screws [2]

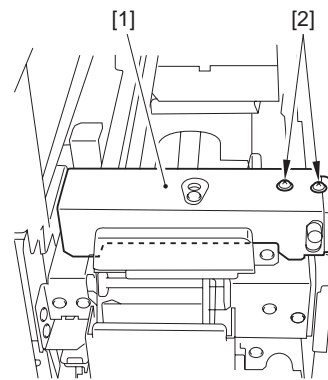

F-1-50

- 6) Shift up the hook (front) [1].

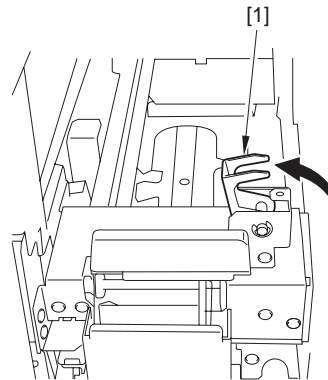

F-1-51

- 7) Remove the screw [1] of the hook (rear) of the folder unit; then, shift it up.

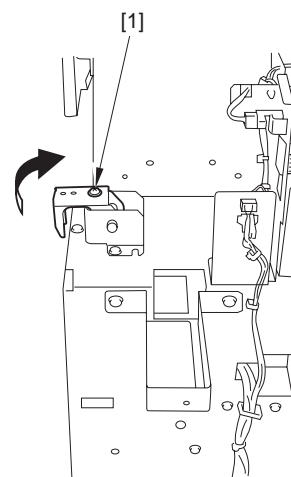

F-1-52

- 8) Fit the positioning pin [1] in the hole [2] of the po-

sitioning plate to join.

<Front>

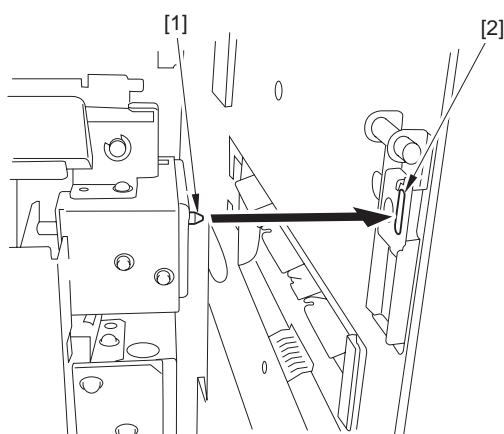

F-1-53

<Rear>

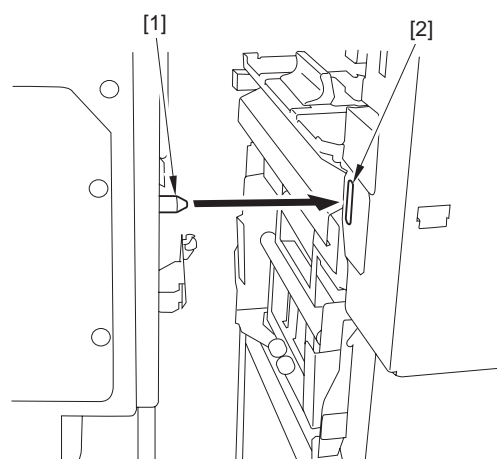

F-1-54



If the condition depicted in figure [A]/[B] exists when connecting the paper folding unit and the host machine, perform steps 1 through 3, and try connecting them again.

[A] the positioning pin [1] and the hole [2] in the positioning plate are in contact.

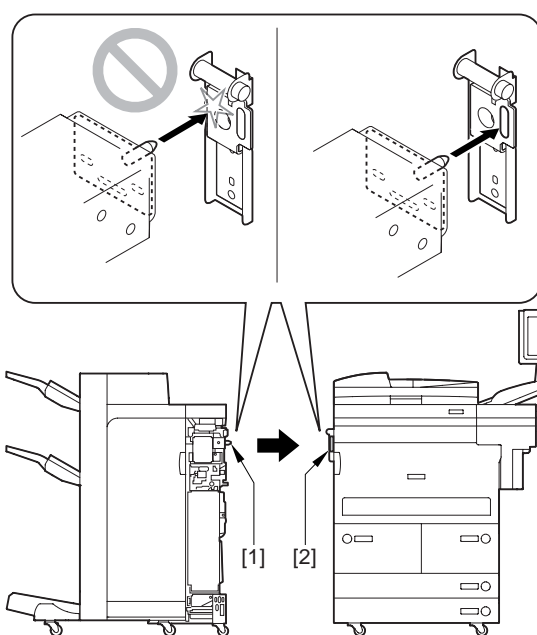

F-1-55

[B] there is a gap under the upper cover [1] of the folding unit.

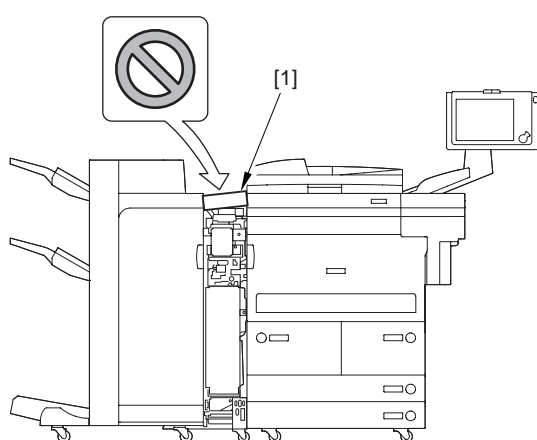

F-1-56

1. Disconnect them, and loosen the 2 screws [2] on the positioning pin [1] of the folding unit.

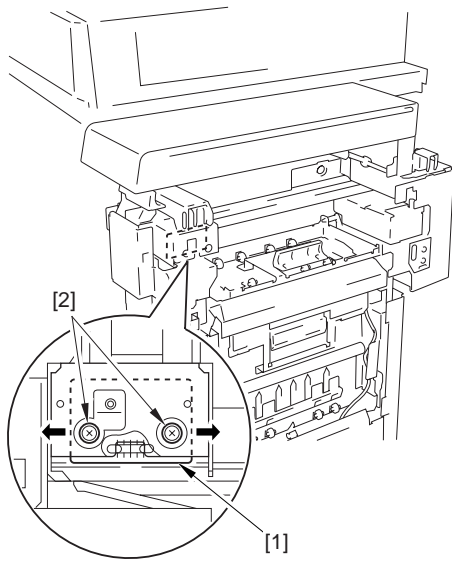

F-1-57

2. While keeping the 2 screws loosened, check to make sure that the positioning pin is properly in the hole of the positioning plate; then, disconnect them carefully so that the pin will not be displaced.
3. Tighten the 2 screws, and connect the paper folding unit to the host machine.

- 9) Shift down the hook (front) [1], and engage it on the latch plate [2].

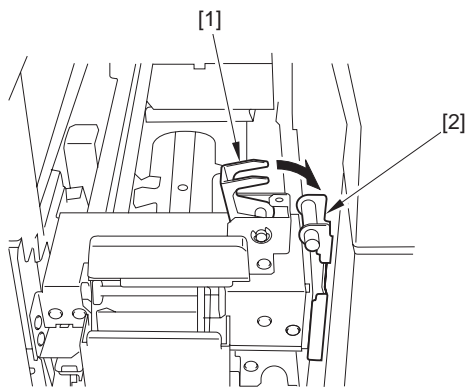

F-1-58

- 10) Fit the magnet catch plate [1] in place.
- 2 screws [2] (Use the screws removed in step 5.)

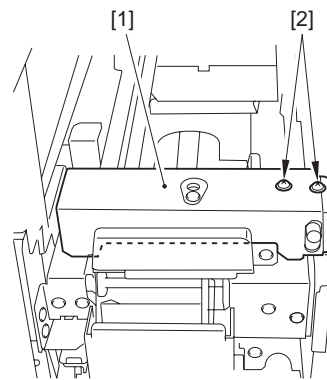

F-1-59

- 11) Shift down the hook (rear), and engage it on the latch plate [2].

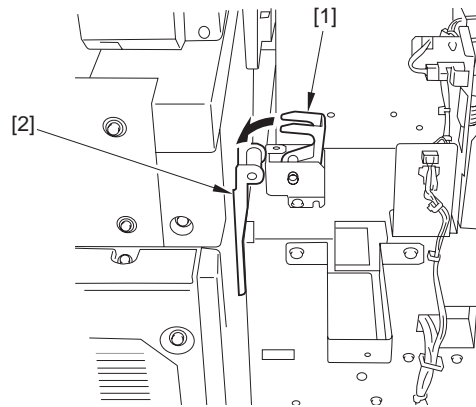

F-1-60

- 12) Fit the reinforcing plate [2] to the hook (rear) [1].
- 2 screws (TP; M4X10; black) [3]

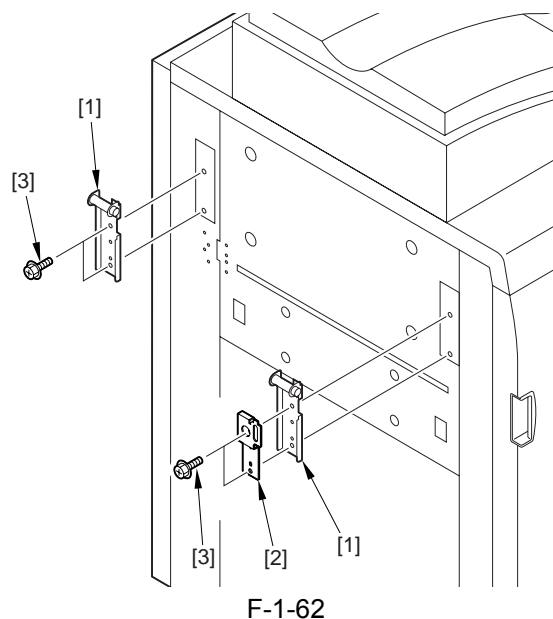
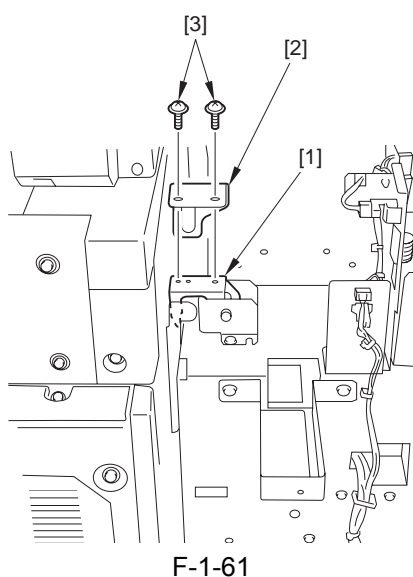

1.3.4 Connecting to the High-Capacity Stacker 0011-6061



Check to be sure that the host machine is off and the power plug is disconnected from the power outlet.

- 1) Fit the latch plate [1] and the folder bin holder (front) [2] to the left side of the high-capacity stacker.
- 4 screws (RS tightening; M4X10; white) [3]

- 2) Fit the positioning pin [1] of the high-capacity stacker in place at [A].
- 2 screws [2] (previously removed (M3))

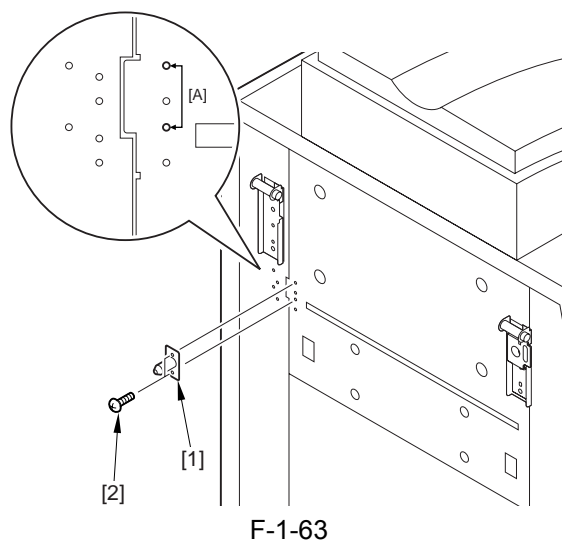

- 3) Fit the front right guide retainer [1] and the rear right guide retainer [2] in place.
- 6 screws (RS tightening; M4X8; white) [3]

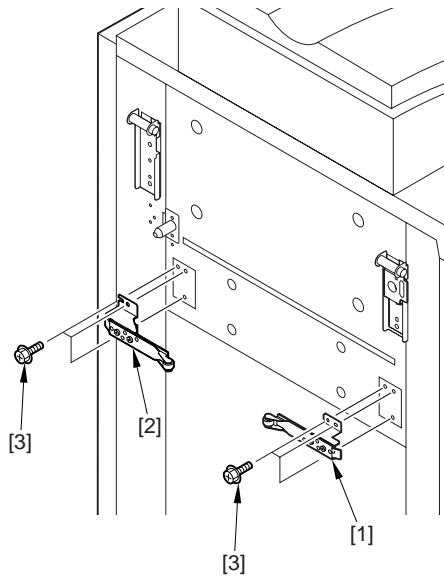

F-1-64

- 4) Open the upper cover of the folder unit, and remove the magnet catch plate [1].
- 2 screws [2]

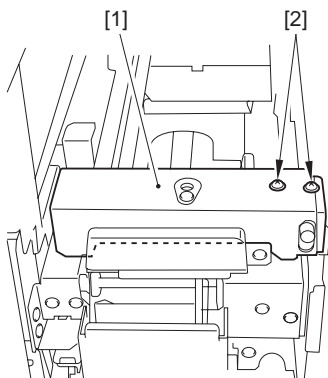

F-1-65

- 5) Shift up the hook (front) [1].

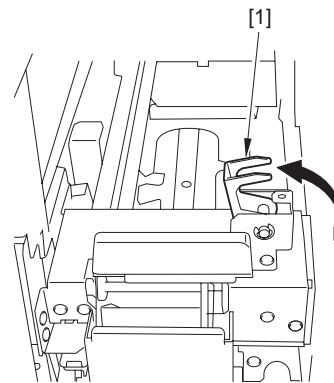

F-1-66

- 6) Remove the screw [1] from the hook (rear) of the folder unit, and shift up the hook.

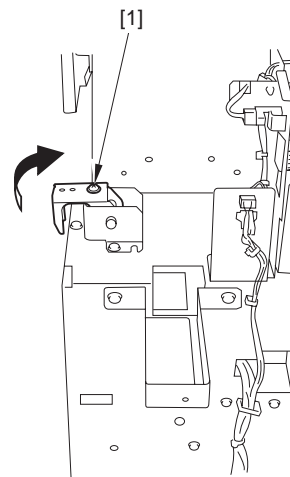

F-1-67

- 7) Fit the positioning pin [1] into the hole [2] of the positioning plate to join.

<Front>

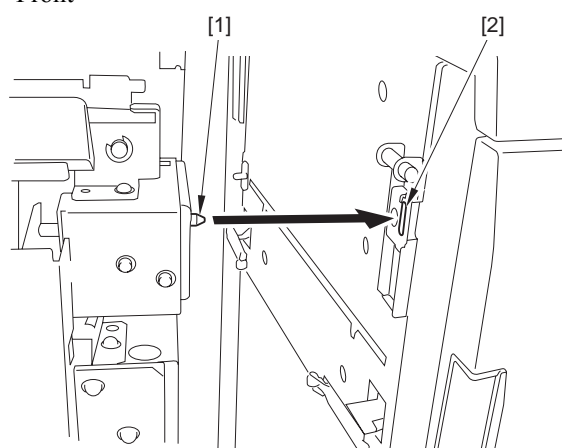

F-1-68

<Rear>

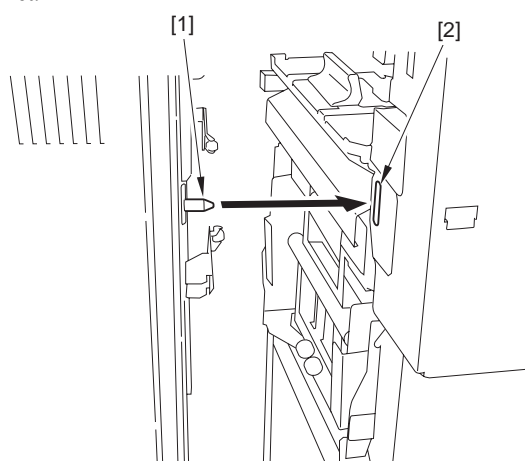

F-1-69



If the condition depicted in figure [A]/[B] exists when connecting the paper folding unit and the high-capacity stacker, perform steps 1 through 3, and try connecting them again.

[A] the positioning pin [1] and the hole [2] in the positioning plate are in contact.

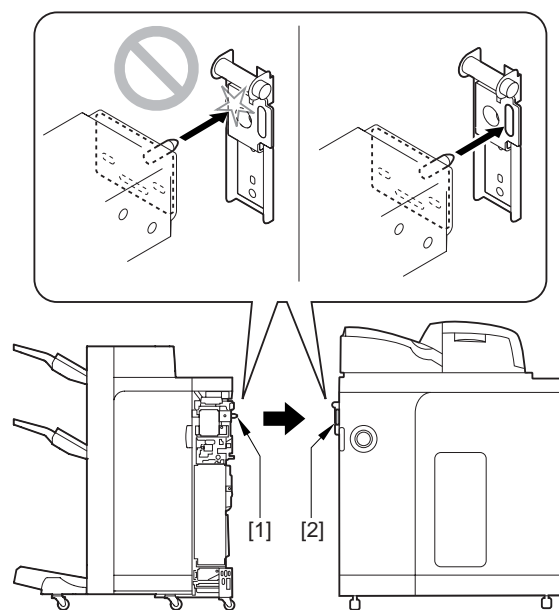

F-1-70

[B] there is a gap under the upper cover [1] of the folding unit.

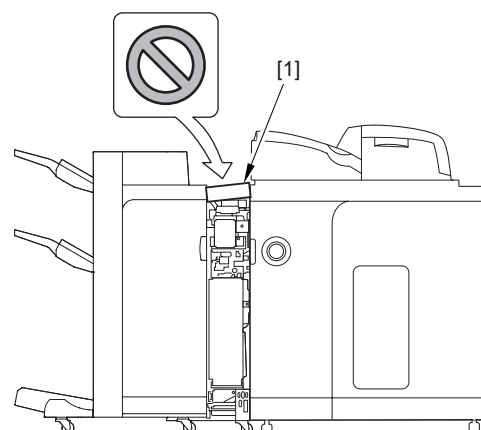

F-1-71

1. Disconnect them, and loosen the 2 screws [2] on the positioning pin [1] of the folding unit.

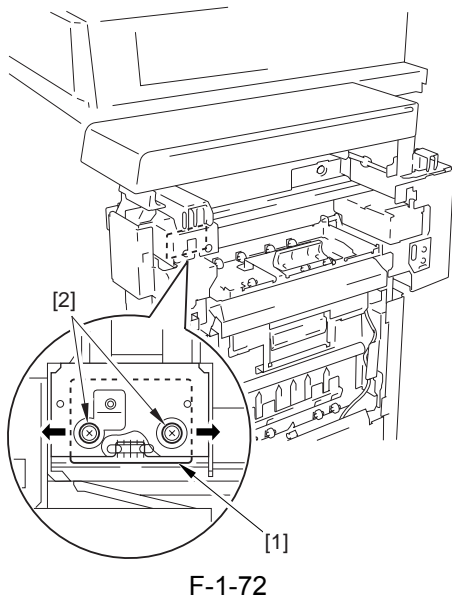

F-1-72

2. While keeping the 2 screws loosened, check to make sure that the positioning pin is properly in the hole of the positioning plate; then, disconnect them carefully so that the pin will not be displaced.
3. Tighten the 2 screws, and connect the paper folding unit to the high-capacity stacker.

- 8) Shift down the hook (front) [1], and engage it on the latch plate [2].

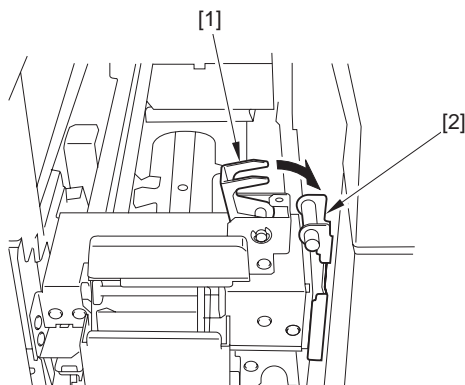

F-1-73

- 9) Fit the magnet catch plate [1] in place.
- 2 screws [2] (Use the screws removed in step 4.)

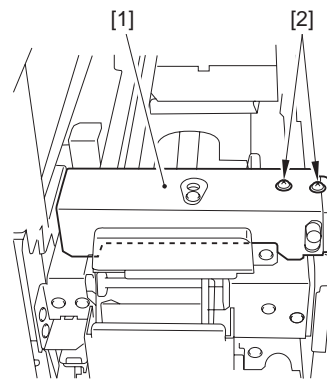

F-1-74

- 10) Shift down the hook (rear) [1], and engage it on the latch plate [2].

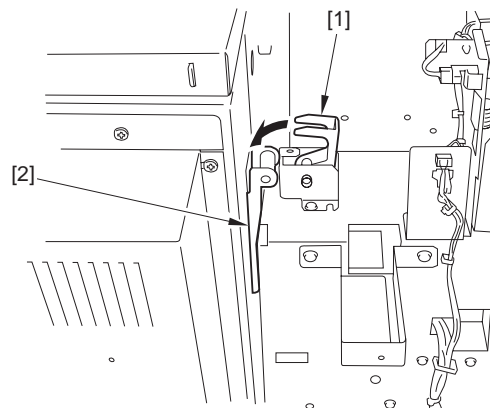

F-1-75

- 11) Fit the reinforcing plate [2] to the hook (rear) [1].
- 2 screws (TP; M4X10; black) [3]

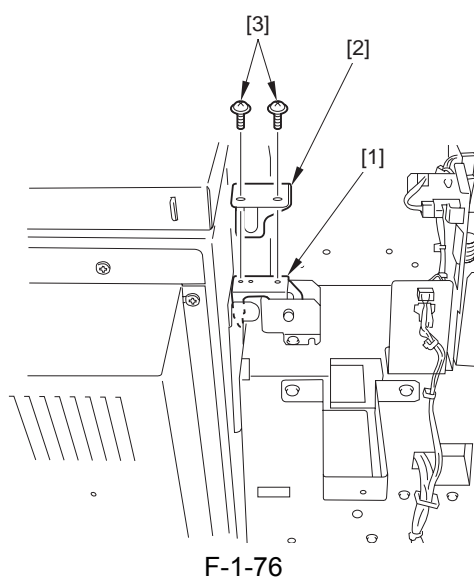

F-1-76

- 12) By referring to the instructions under "Mounting the Covers", mount the front cover and the rear cover to the folder unit.
- 13) Remove the screw [1] from the rear cover of the high-capacity stacker.

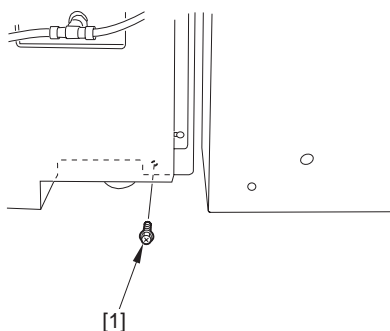

F-1-77

- 14) Fit the included shunt cable [1] to the finisher.
- 1 screw [2] (Use the screw removed in step 13).)
 - 1 screw (RS tightening; M4X10; white) [3]

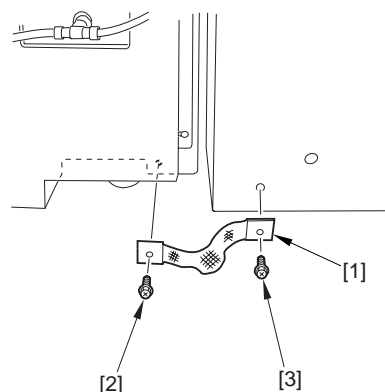

F-1-78

- 15) By referring to the instructions in "After the Work", connect the signal cable to the finisher and the high-capacity stacker.



For instructions on connection to the host machine, see the "high-Capacity Stacker Installation Procedure".

1.3.5 Connecting to the Professional Puncher 0011-6029



If you are connecting a professional puncher, be sure to mount the accessories power supply unit for the finisher in advance.

- 1) Fit the latch plate [1] and the folder bin plate (front) [2] to the left side of the professional puncher.
- 4 screws (RS tightening; M4X10; white) [3]

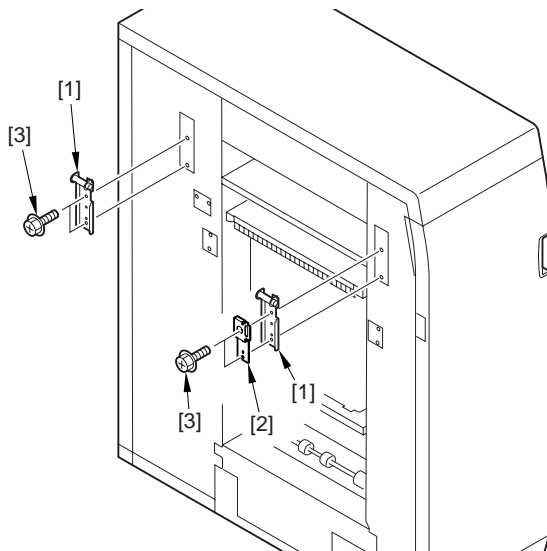

F-1-79

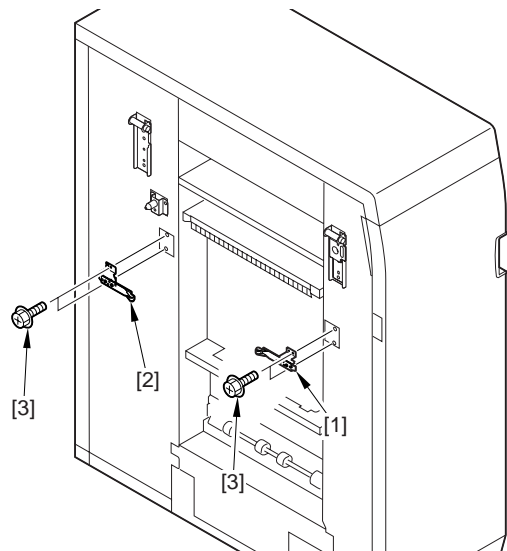

F-1-81

- 2) Fit the positioning pin [1] in place.
- 2 screws (RS tightening; M4X10; white) [2]

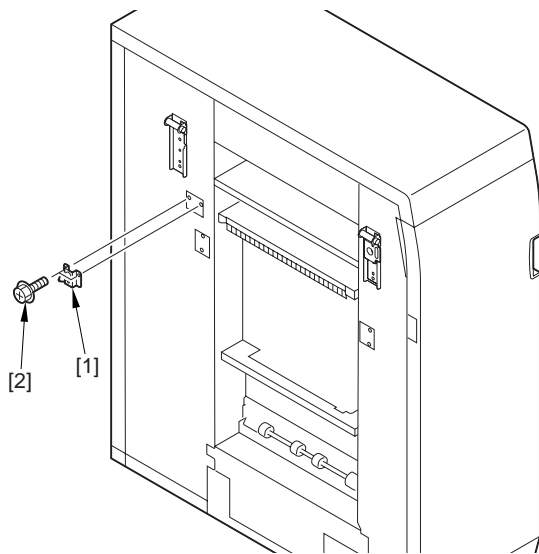

F-1-80

- 4) Open the upper cover of the folder unit, and remove the magnet catch plate [1].
- 2 screws [2]

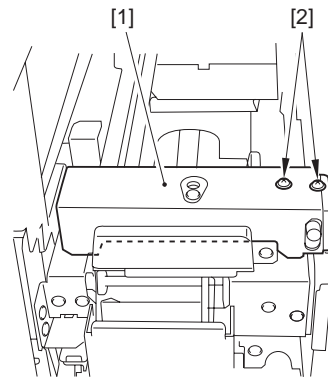

F-1-82

- 3) Mount the front right guide retainer [1] and the rear right guide retainer [2].
- 4 screws (RS tightening; M4X8; white) [3]

- 5) Shift up the hook (front) [1].

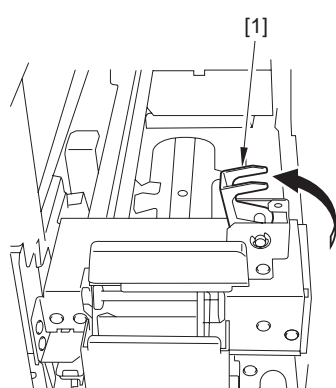

F-1-83

- 6) Remove the screw [1] from the hook (rear) of the folder unit; then, shift up the hook.

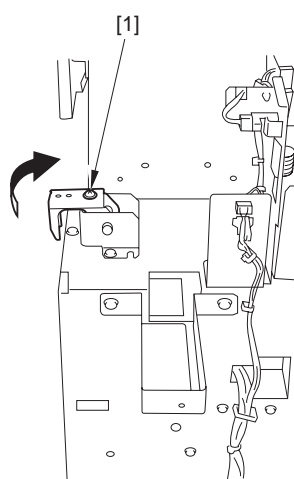

F-1-84

- 7) Fit the positioning pin [1] into the hole [2] of the positioning plate to join.

<Front>

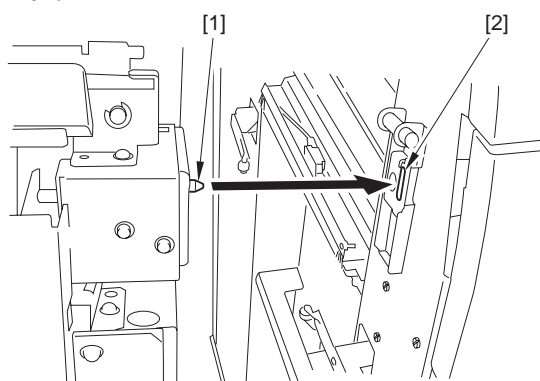

F-1-85

<Rear>

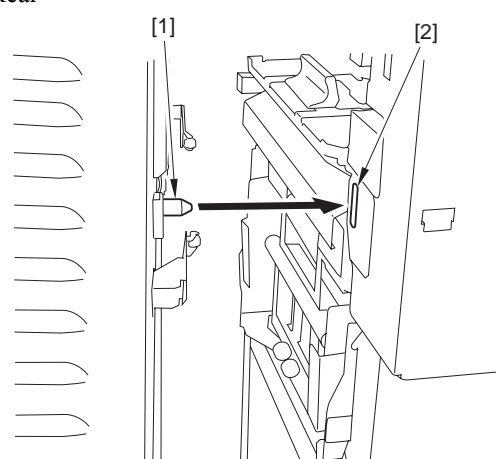

F-1-86



If the condition depicted in figure [A]/[B] exits when connecting the paper folding unit and the professional puncher, perform steps 1 through 3, and try connecting them again.

[A] the positioning pin [1] and the hole [2] in the positioning plate are in contact.

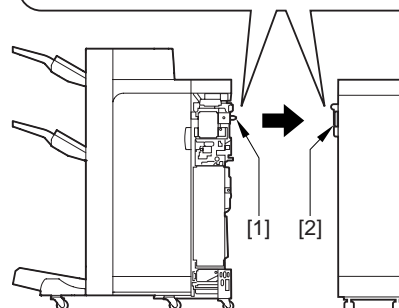
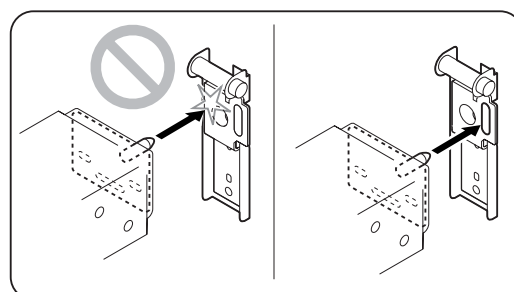

F-1-87

[B] there is a gap under the upper cover [1] of the folding unit.

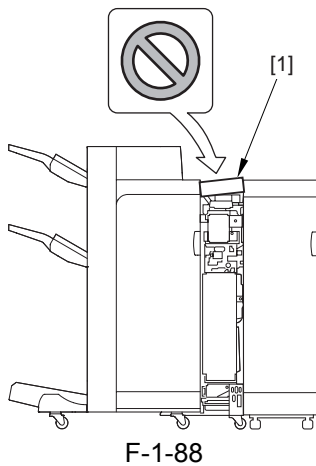

1. Disconnect them, and loosen the 2 screws [2] on the positioning pin [1] of the folding unit.

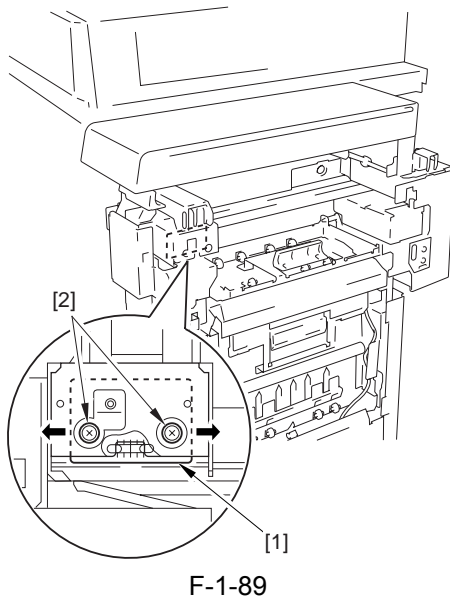

2. While keeping the 2 screws loosened, check to make sure that the positioning pin is properly in the hole of the positioning plate; then, disconnect them carefully so that the pin will not be displaced.
3. Tighten the 2 screws, and connect the paper folding unit to the professional puncher.

- 8) Shift down the hook (front), and engage it on the latch plate [2].

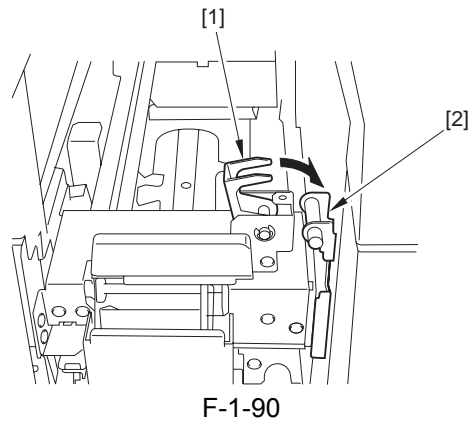

- 9) Fit the magnet catch plate [1] in place.
- 2 screws [2] (Use the screw removed in step 4).)

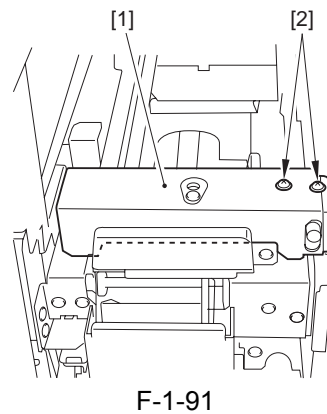

- 10) Shift down the hook (rear) [1], and engage it on the latch plate [2].

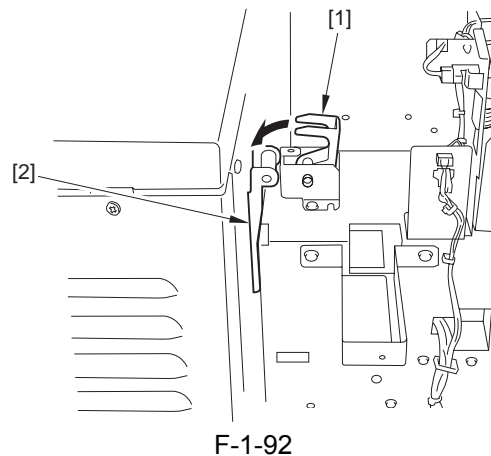

- 11) Fit the reinforcing plate [2] to the hook (rear) [1].

- 2 screws (TP; M4X10; black) [3]

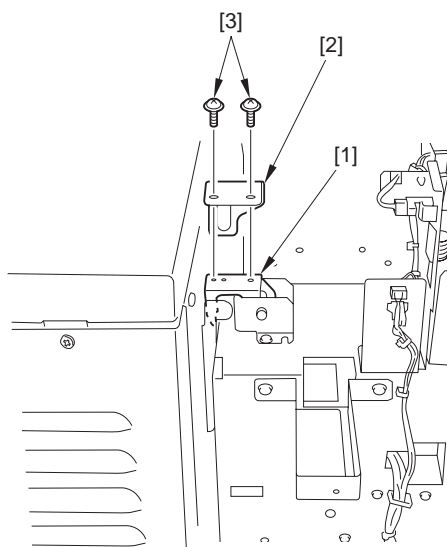

F-1-93

12) Remove the face plate [1] from the side of the finisher controller. (The removed face plate will no longer be used.)

- 2 screws [2]

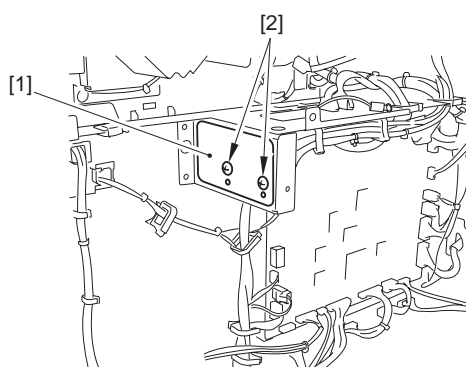

F-1-94

13) Fit the communication cable [2] that comes with the professional puncher to the finisher controller [1].

- connector [3]

- 2 screws [4] (Use the screws removed in step 12).)

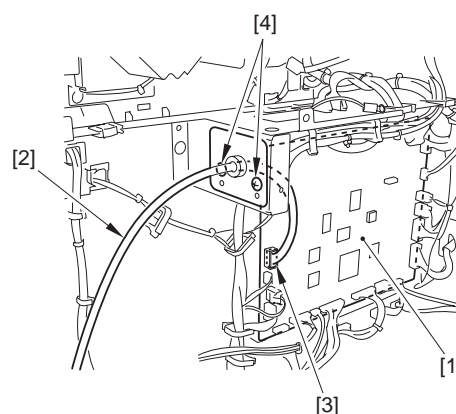

F-1-95

14) Mount the front cover and the rear cover to the folder unit by referring to the instructions under "Mounting the Covers" in this booklet.

15) Connect the connector [1] of the communication cable to the professional puncher.

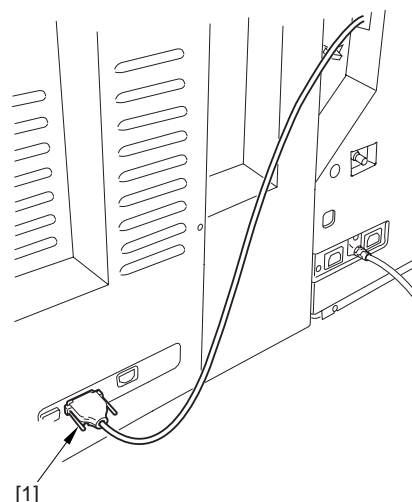

F-1-96

16) Connect the power cable [1] that comes with the professional puncher to the finisher and the professional puncher.

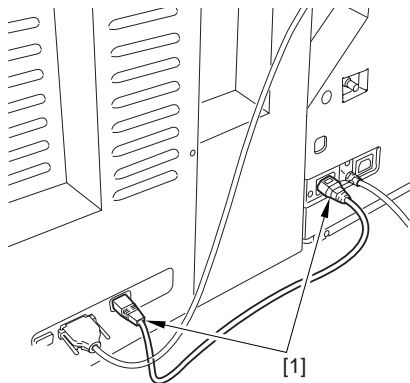

F-1-97

17) Fit the included Plug cover [1] to the professional puncher.

- 1 screws (binding; M4) [2] (included with the professional puncher)

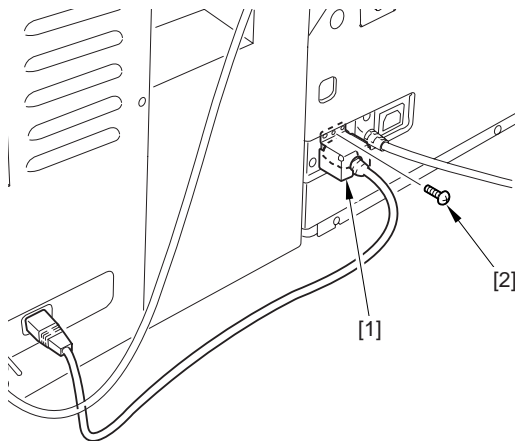

F-1-98

18) Remove the screw [1] from the professional puncher rear cover.

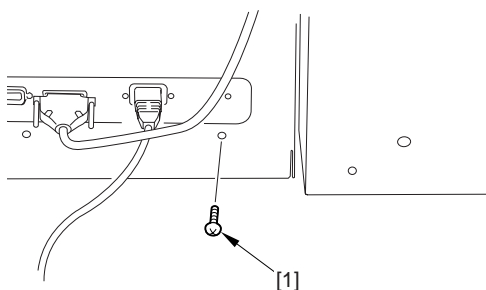

F-1-99

19) Fit the shunt cable [1] that comes with the finisher.

- 1 screw [2] (Use the screw removed in step 18).)
- 1 screw (RS tightening; M4X10; white) [3]

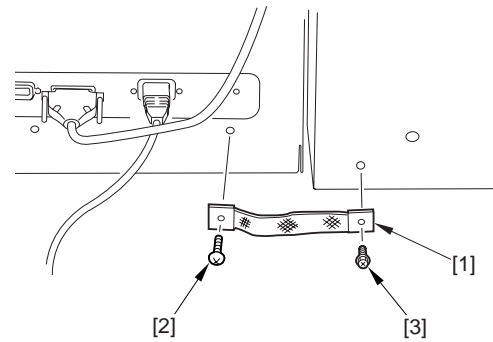

F-1-100



For instructions on connecting to the host machine, see the "Professional Puncher Installation Procedure".

1.3.6 Mounting the Covers

0011-4884

- 1) Slide out the folder assembly.
- 2) Mount the front cover [1] by fitting its claw [2] in the folder unit.
 - 1 screw (binding; w/washer; M4X6; white) [3]
 - 2 screws (binding; M4X6; white) [4]

<Left>

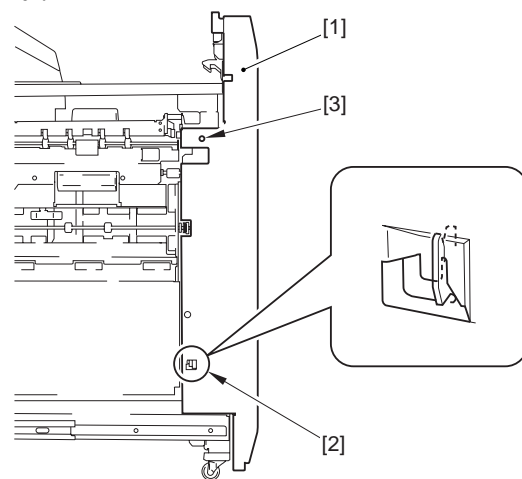

F-1-101

<Right>

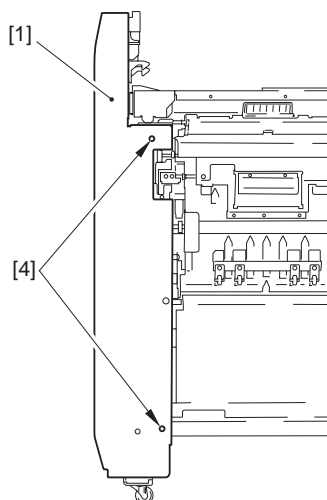

F-1-102

- 3) Slide the folder unit back in.
- 4) Fit the rear cover [1] to the folder unit.
 - 1 screw (binding; M4X6; white) [2]
 - 1 screw (binding; w/washer; M4X6; white) [3]

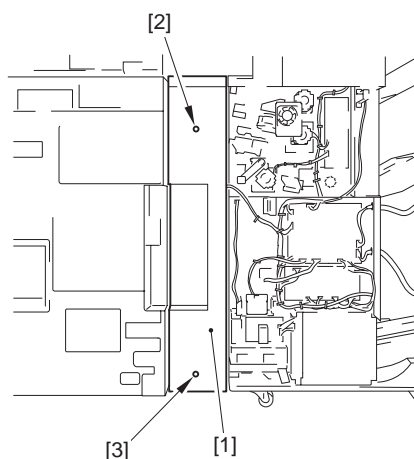

F-1-103

- 5) Mount the covers of the finisher you may have removed.
 - lower rear cover
 - middle rear cover
 - inside cover (upper)
 - knob found on inside cover (upper)
- 6) Close the front cover of the finisher.

1.3.7 Mounting the Sub Tray Drive Unit

0011-4895

- 1) Remove the tray B (lower) [1].
 - 4 screws [2]

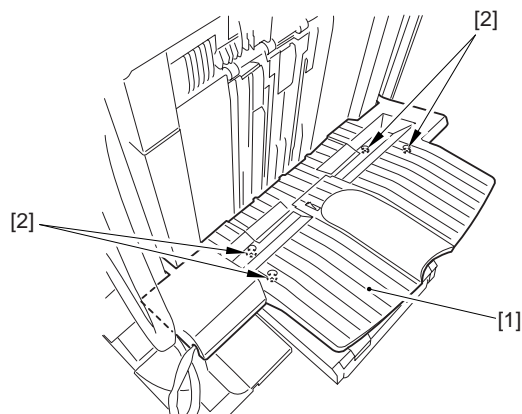

F-1-104

- 2) Remove the sub tray [1] from the tray B.

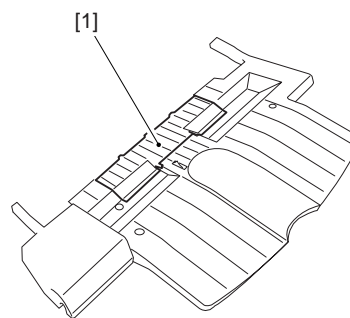

F-1-105

- 3) Attach the 2 sponge pieces [1] behind the sub tray.

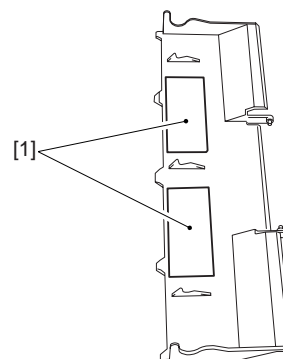

F-1-106

- 4) Attach the stopper rubber piece [1] to tray B.

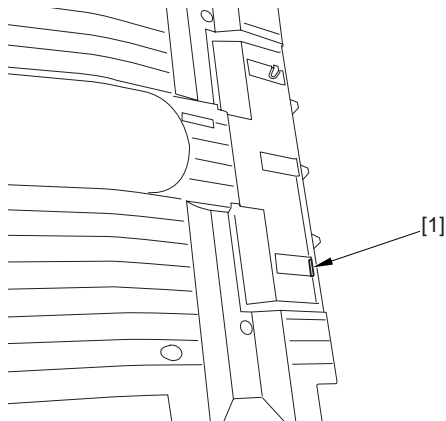

F-1-107

- 5) Match the spring [1] of the lever unit against the groove of the lever [2]; then, rotate and hold the sub tray shaft [3] as shown.

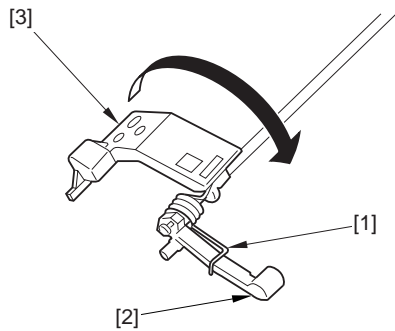

F-1-108

- 6) Fit the lever unit [1] in the bearing [2] found behind tray B.

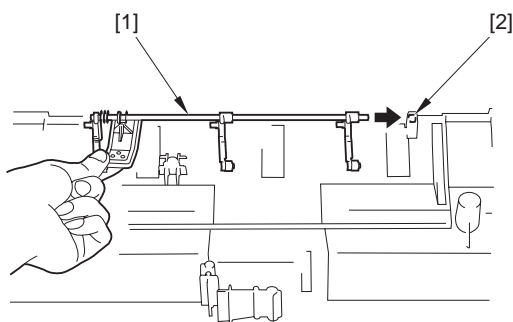

F-1-109

- 7) Fix the sub tray shaft [2] of the lever unit [1] in place.

- 1 screw (P tightening; M4X8; black) [3]

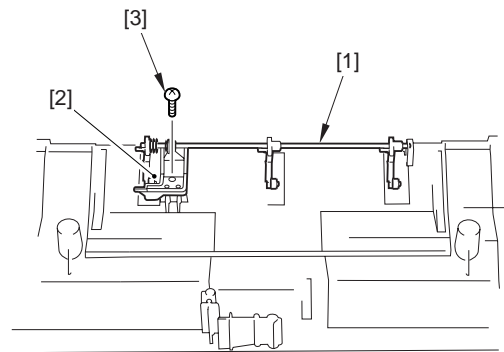

F-1-110

- 8) Fix the solenoid unit [1] in place by fitting its lever [2] in the shaft [3] of the lever unit.

- screw (P tightening; M4X8; black) [4]

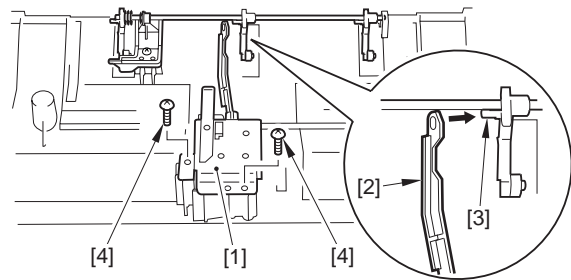

F-1-111



The shaft [1] of the solenoid unit is not fixed in place and, therefore, the lever [2] may be fitted upside down. Be sure it is in the correct orientation by referring to the figure.

- 9) Check to be sure that the roll [3] of the lever unit is not sticking beyond the tray surface [4].

As necessary, correct the height as instructed in step 10).

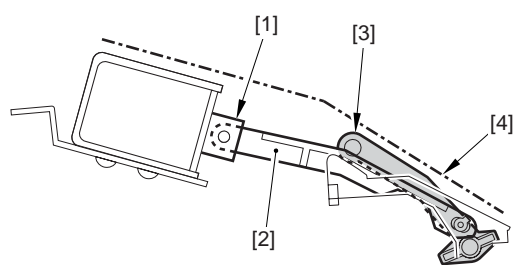

F-1-112

10) Adjust the height.

10-1) Loosen the 3 screws [2] of the solenoid unit [1].

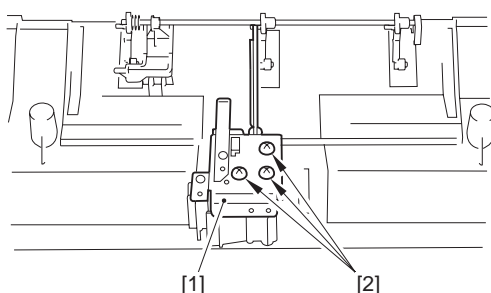

F-1-113

10-2) Push the solenoid shaft [2] into the solenoid [1] in the direction of [A] so that it is in contact.

10-3) While keeping the solenoid in this condition, hook your finger on the solenoid shaft [2], and pull the solenoid unit [1] in the direction of [B].

10-4) Pull it until the roll [3] of the lever unit butts against the sub tray shaft [4], and tighten the 3 screws [5] in this condition.

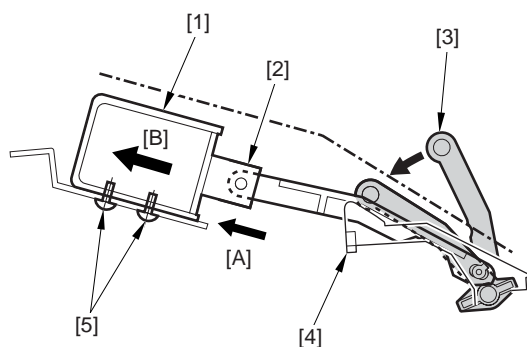

F-1-114

11) Fit the sub tray to tray B.

12) Connect the cable [1] for solenoid drive to the so-

lenoid unit [2].

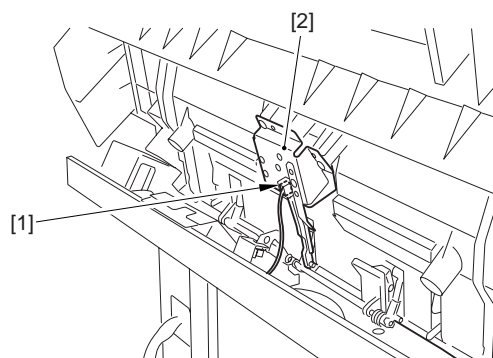

F-1-115

13) Mount tray B using 4 screws.

1.3.8 After the Work

0011-6027

1) Remove the screw [1] from the host machine's rear cover.

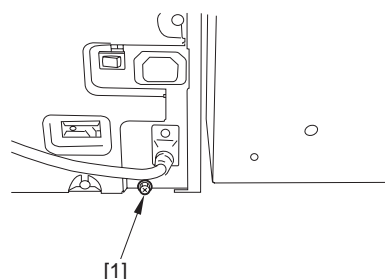

F-1-116

2) Fit the included shunt cable [1] to the finisher.

- 1 screw [2] (Use the screw removed in step 1).)
- 1 screw (RS tightening; M4X10; white) [3]

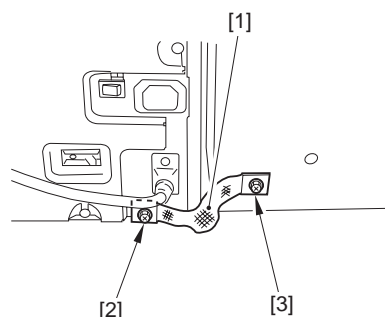

F-1-117

3) By referring to the instructions in "After the Work"

under "Finisher/Saddle Finisher Installation Procedure", connect the signal cable to the finisher and the host machine.

- 4) Set the position of the accessory by referring to the descriptions under "After the Work" of the "Finisher/Saddle Finisher Installation Procedure".

1.3.9 Checking the Height

0011-7514

Some sites of installation call for the adjustment of finisher height on account of floor condition. Incorrect height will lead to frequent jams in the finisher pickup assembly. Be sure to check the height and, as necessary, make the necessary adjustments:

- 1) Check the height of the folder unit and the host machine. The difference in height between the upper cover surface [1] of the folder unit and the left upper surface [2] of the host machine must be ± 2 mm.

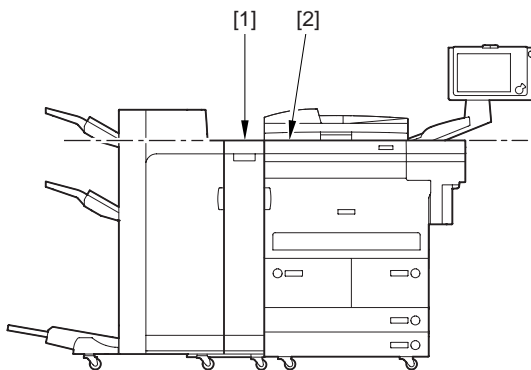

F-1-118

- 2) If the difference is not ± 2 mm, adjust the height by referring to the instructions under "Adjusting the Height" in the "Finisher/Saddle Finisher Installation Procedure".

1.4 Making Adjustments

1.4.1 Horizontal Registration/Skew Adjustment

0011-7350

Execute horizontal registration/skew adjustment mode, and check to see if the values are as indicated.

1. Checking the Adjustment Values

- 1) Turn on the finisher and the host machine in the order indicated.
- 2) Open the front cover, and fit the door switch actuator into the door switch [1].

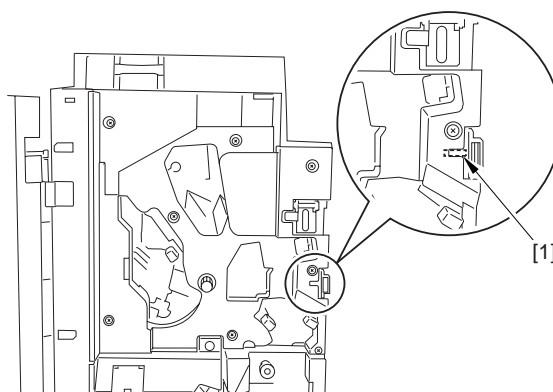

F-1-119

- 3) Remove the switch cover [1] of the inside cover (lower).
- 1 screw [2]

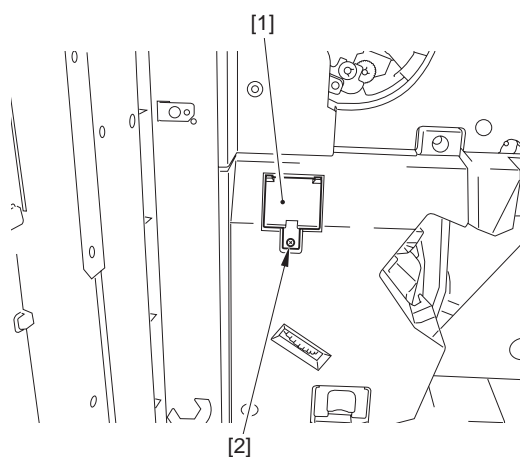

F-1-120

- 4) Set the DIP switch SW382 [1] on the switch PCB as shown (1, 4, 6, 8: ON), and press the ENTER (SW385) button [2] so that LED [3] goes on ('0').

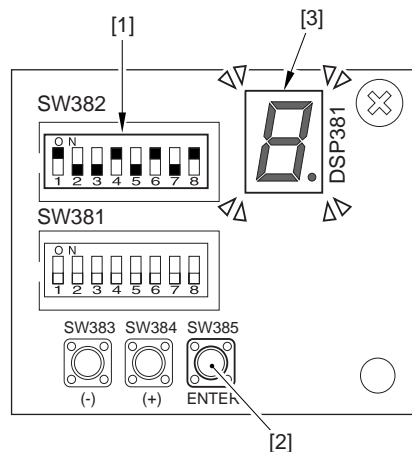

F-1-121

5) Place a single sheet of A4/LTR paper, and select ADF or copyboard mode; then, set '3' as the copy count, and execute printing.

6) See that the LED [1] indicates the horizontal registration/skew adjustment value.

The indication will be 'A' -> 'horizontal registration adjustment value' -> 'b' -> 'skew adjustment value'; take note of the values.

- horizontal registration adjustment value (reference only): -3 to +3 mm (1 index: equivalent of 1 mm)
- skew adjustment value (reference only); -2 to +2 mm (1 adjusting spacer: equivalent of 1 mm)

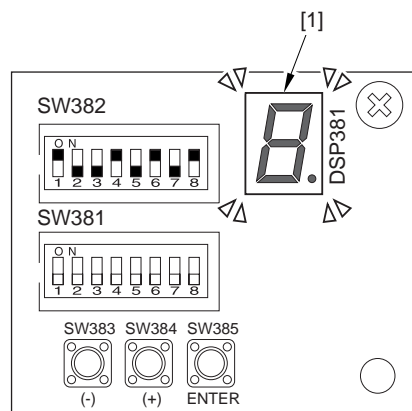

F-1-122

7) Press the ENTER button to end adjustment mode.

- If the adjustment value (reference only) is as indicated, put the DIP switch back to its initial setting.
- If the adjustment value (reference only) is not as indicated, on the other hand, perform the instructions under "2. Horizontal Registration Adjustment" or "3. Skew Adjustment".

8) Turn off the host machine and then the finisher in the order indicated.

2. Horizontal Registration Adjustment

1) Remove the front cover and the rear cover, and disconnect the host machine and the folder unit.

2) Loosen the 2 screws [2] of the positioning plate [1] found on the right side.

3) If the adjustment value is a '+' value, move it in the direction of [A], and tighten the screw [2].

If the value checked was a '-' value, on the other hand, move the plate in the direction of [B], and tighten the screws [2]. (1 memory -> Comparable to 1mm)

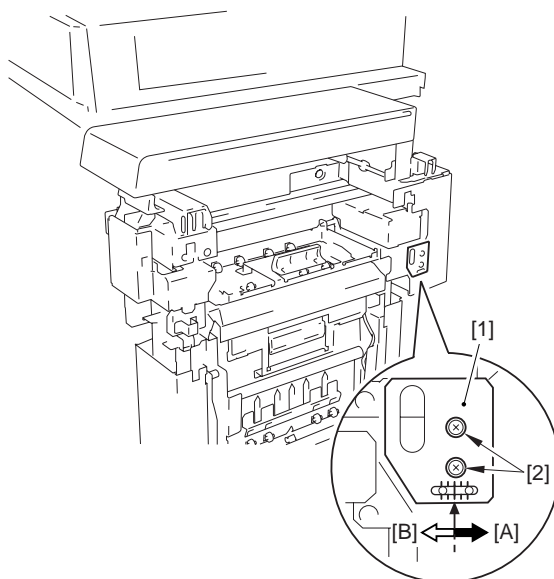

F-1-123

4) Loosen the 2 screws [2] on the positioning pin [1] found on the right side.

5) Move the plate in the direction and over the distance (number of indexes) used in step 3); then, tighten the screws [2].

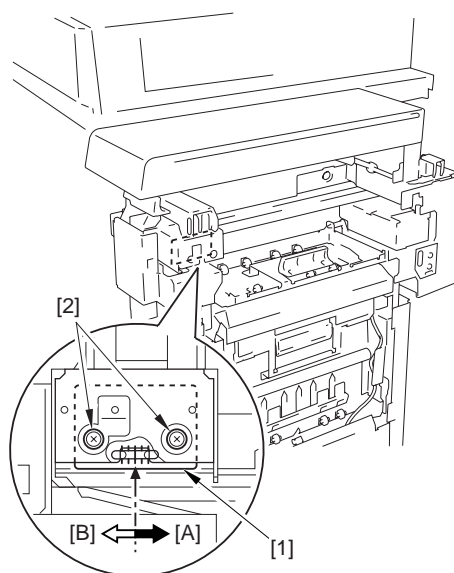

F-1-124

3. Skew Adjustment

If the skew adjustment value is as indicated, go to step 5).

- 1) If the adjustment value is a '+' value, remove the latch plate [1] and the folder pin plate [2] from the front of the host machine. (The removed screws will no longer be used.)
 - 2) Fit an adjusting spacer [3] between the host machine and the latch plate [1].
 - 2 screws (RS tightening; M4X12; white) [4]
-



A single adjusting spacer [3] enables adjustment up to +1 mm. Use up to 3 spacers as needed.

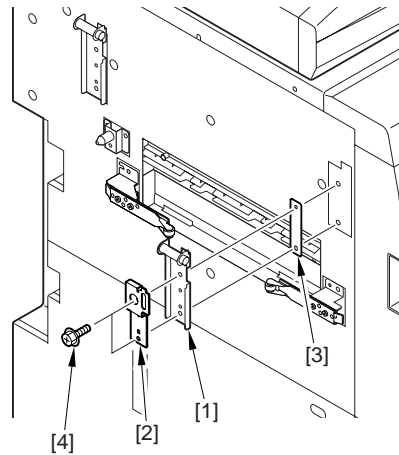

F-1-125

- 3) If the adjustment value is a '-' value, remove the latch plate [1] from the front of the machine. (The removed screw will no longer be used.)
 - 4) Fit an adjusting spacer [2] between the host machine and the latch plate [1].
 - 2 screws (RS tightening; M4X12; white) [3]
-



A single adjusting spacer [2] enables adjustment of up to +1 mm. Use up to 3 spacers as needed.

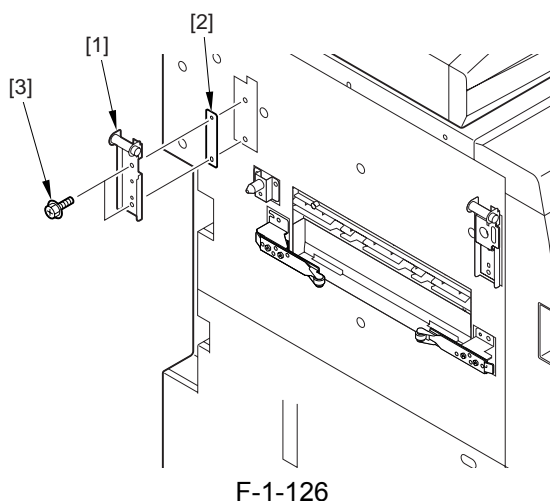

5) Connect the host machine and the folder unit.

6) Turn on the finisher and then the host machine in the order indicated.

7) Check the adjustment values once again.

If the adjustment value indicated by the LED is within a specific range, press the ENTER key to end adjustment mode. Otherwise, go through the steps for a second time; if the result is more or less the indicated value (reference only), end the work.

8) Put the DIP switch back to its initial setting, and put back the covers you may have removed.

1.4.2 Folding Stopper Adjustment

0011-6924

The paper folding position and the angle may be adjusted by adjusting the position of the stopper. Make adjustments to suit the needs of the user.



If the paper size is 11X17, you must adjust (folding position) of the No. 1 stopper and the No. 2 stopper. (US and Canada only)

1) Turn on the finisher and the host machine in the order indicated.

2) On the control panel of the host machine, set the paper size and select Z-fold; then, execute copying.

3) Check the discrepancy (Z1 thorough Z6) of the Z-folded output; then, correct the discrepancy.

T-1-1

| | Dimension | Adjusting stopper | Adjustment |
|----|-----------|-------------------|------------|
| Z1 | long | No. 1 stopper | lower |
| | short | | raise |
| Z2 | long | No. 2 stopper | raise |
| | short | | lower |

| | Dimension | Adjusting stopper | Adjustment |
|----|-----------|-------------------|------------|
| Z3 | long | No. 1 stopper | raise |
| Z5 | short | | lower |
| Z4 | long | No. 2 stopper | raise |
| Z6 | short | | lower |

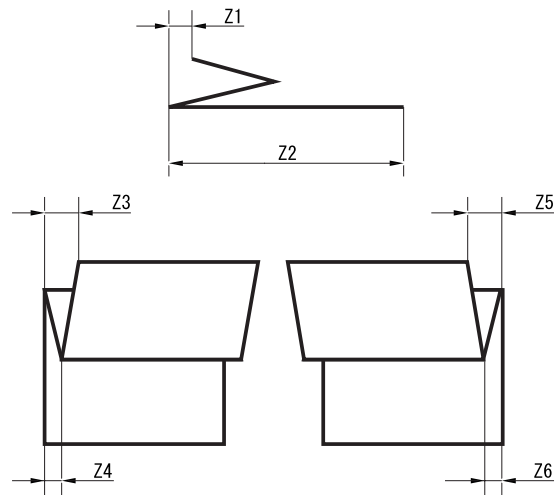

F-1-127

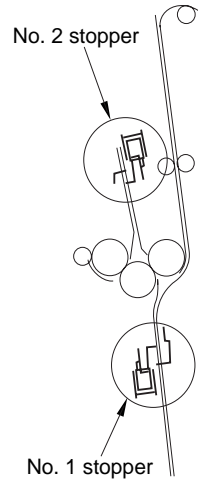

F-1-128

1. Adjusting the No. 1 Stopper

- 1) Open the upper cover [1], and slide out the folder assembly [2].

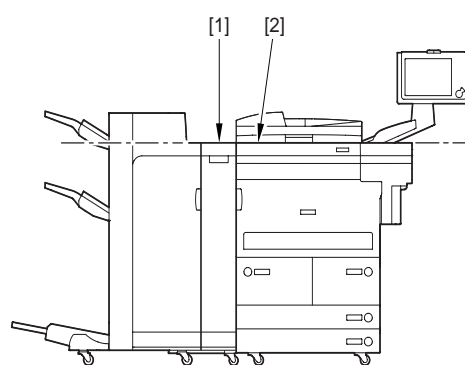

F-1-129

- 2) Remove the lower right cover [1].
- 2 screws [2]

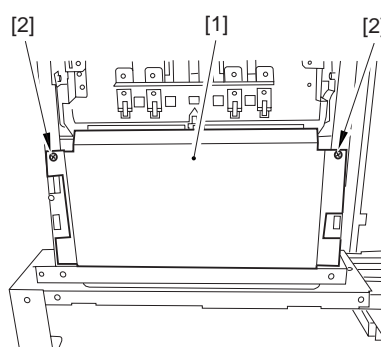

F-1-130

- 3) Remove the lower left cover [1].
- 2 screws [2]

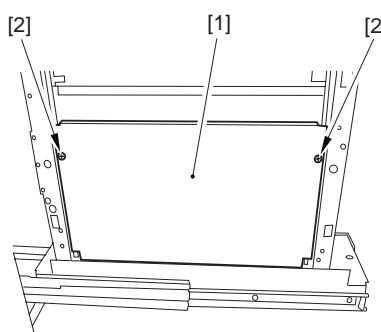

F-1-131

A) Adjusting the Folding Position

- A-1) Loosen the 2 screws [1] on the outside, and move the No. 1 stopper [2] up/down to adjust the folding position.
- if Z1 is too long, lower the position of the No. 1 stopper.
 - if Z1 is too short, raise the position of the No. 1 stopper.
- If A3/11X17,

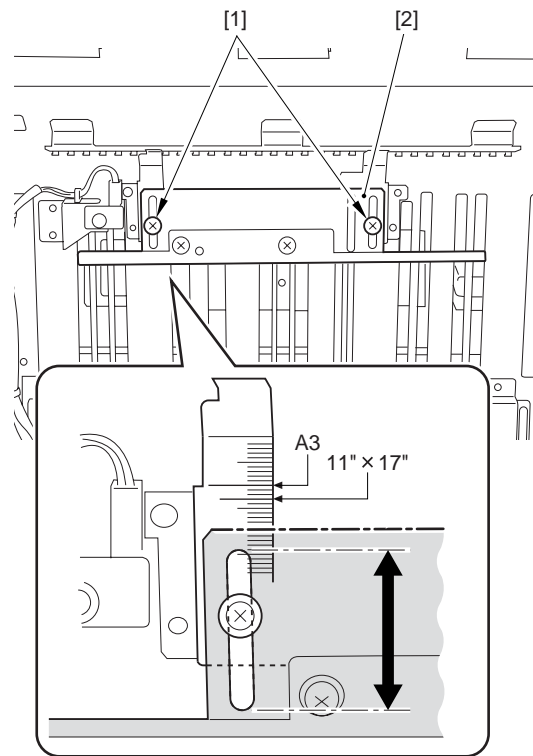

F-1-132

- If B4,

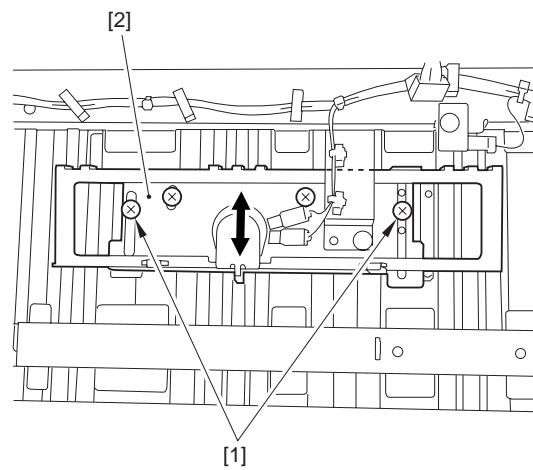

F-1-133

B) Angle Adjustment

B-1) Loosen the 2 screws [1] on the inside, and move the No. 1 stopper [3] up/down against the line of reference [2] to correct the angle.

- if Z3 is too long, raise the angle of the No. 1 stopper.

- if Z5 is too long, lower the angle of the No. 1 stopper.

- If A3/11X17,

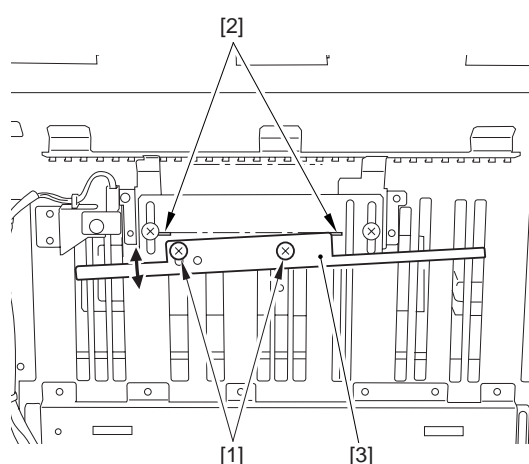

F-1-134

- If B4,

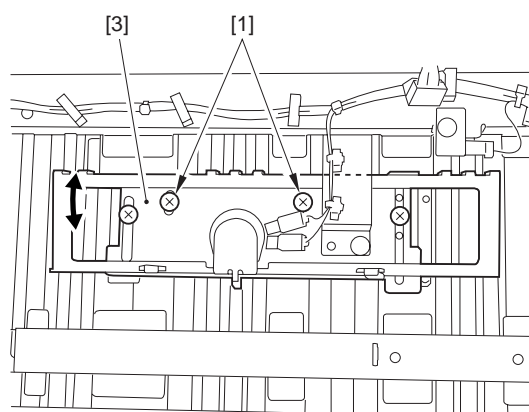

F-1-135

3) Put back the covers and folder unit you have removed.

2. Adjusting the No. 2 Stopper

1) Open the upper cover, and slide out the folder unit; then, open the left guide [1].

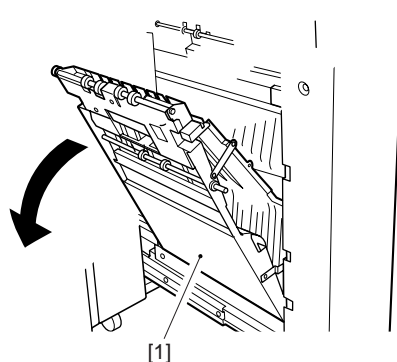

F-1-136

A) Adjusting the Folding Position

A-1) Loosen the 2 screws [1] on the outside, and move the No. 2 stopper [3] up/down against the line of reference [2] to adjust the folding position.

- if Z2 is too long, raise the folding position of the No. 2 stopper.
- if Z2 is too short, lower the folding position of the No. 2 stopper.

- If A3/11X17,

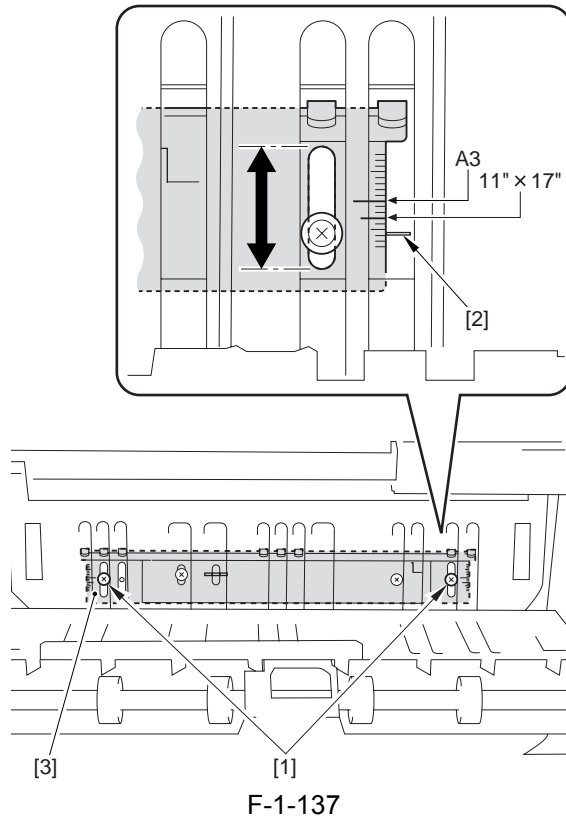

- If B4,

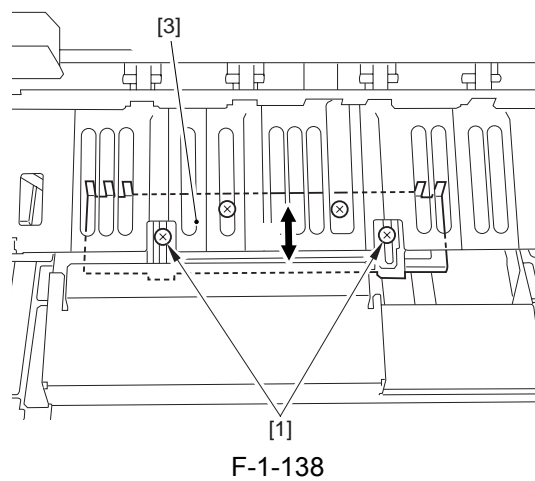

B) Angle Adjustment

B-1) Loosen the 2 screws [1] on the inside, and move the No. 2 stopper [3] up/down against the line of reference [2] to adjust the angle.

- if Z4 is too long, raise the angle of the No. 2 stopper.
- if Z6 is too long, lower the angle of the No. 2 stopper.

- If A3/11X17,

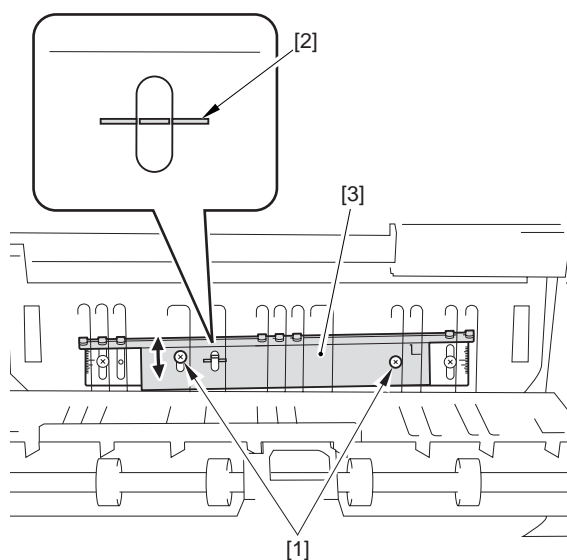

F-1-139

- If B4,

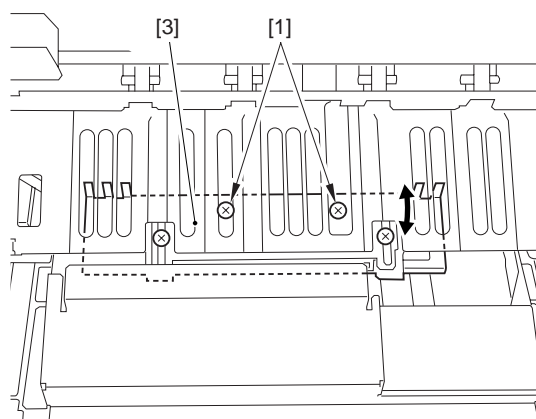

F-1-140

2) Put back the left guide and the folder unit.

Feb 7 2006

Canon